

House Type Schedule:

Type:	No:	Beds:
'A'	1	1
'B'	1	1
'C'	5	2
'D1'	2	2
'D3'	1	2
'E'	14	3
'F'	3	3
'G'	25	4
'H'	12	4
'J'	2	4
<b>Total</b>	<b>66no.</b>	

Key:

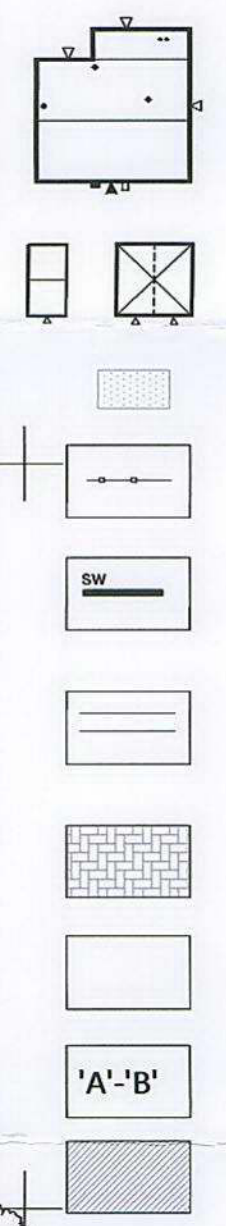

- Proposed house type, including rear and front door positions, drainage points, meter positions, name, handing.
- Proposed garages, single or double with door positions.
- Proposed car spaces, 2.6m wide x 4.8m long.
- 1.8m high close board fence
- 1.8m screen wall
- Proposed footpaths & patio areas to be surfaced with 600x600mm Marshalls Saxon Concrete Paving Slabs, or similar approved. Colour: Buff. Finish: Textured. Slabs to be laid stack bond.
- Shared surface areas to be surfaced with Marshall Tegula Concrete Sett Paving, or similar approved. Colour: Pennant Grey. Paviours to be laid stretcher course.
- Parking bays & entrance threshold to be tarmaced
- Site boundary between points A-B to be constructed in 1.8m high close boarded fencing.
- Proposed sewer easement (6m wide).



Betws Industrial Park, Foundry Road  
Ammanford, Carm. SA18 2LS  
Tel: 01269 591103 Fax: 01269 596207

Project  
Area North of Access Road  
Betws Colliery Ammanford.

Drawing Title  
Planning Layout

Date	Scale	Drawn
12/04/11	1:500@A2	MRD
Job. Ref./No.	Rev.	
1055/01		

CCC PLANNING SERVICES  
APPLIC No DATE  
E 2 4 7 4 2 12 MAY 2011  
VALID APPLICATION