

Site Plan & Landscape Plan
Dinas Yard, Kidwelly, Carmarthenshire.

PLANTING SPECIFICATION
 Tree Planting – 3-4 Metres Apart
 Ground Preparation and Tree Pit Excavation
 • Remove existing weeds where necessary.
 • Excavate tree pits of at least 75mm diameter greater than the root system and no deeper than the rootball container depth.
 • Soil dug during excavation should be put to one side separating topsoil and subsoil where possible.
 Tree Planting
 • Trees to be planted as shown on plan.
 • Typical root depth is 900mm. The first 300mm to be made up of topsoil whilst subsoil provides the remainder of the minimum rooting depth.
 • The root system of the tree should be wetted before planting and trees planted to correct depth.
 • Tree pits to be backfilled with the excavated topsoil. Backfill should be added gradually in layers of 150mm to 230mm depth, ensuring the tree is held upright.
 • General-purpose slow release fertiliser and Tree Planting and Mulching Compost at the rate of are to be incorporated into the top 150mm of topsoil during the final cultivations.
 • Immediately after planting, all trees should be saturated to field capacity.
 • Ornamental composted bark mulch will be spread to a depth of 75mm across a 0.8m diameter circle around individual trees.
 Hedgerow
 Ground Preparation
 • Existing weeds will be treated where necessary.
 Planting
 • The planting arrangement shall follow the plan
 • Planting per metre
 • Dig trench twice width and same height as clod
 • Break soil at the bottom of the trench and mix in well-rotten compost manure
 • Mix small portion of the soil from the trench with manure
 • Place clod in trench ensuring the plant stands straight and the top of the clod is at ground level
 • Fill back the trench with the mixture of soil and manure firming with feet
 • Water plants deeply and keep well-watered throughout the first growing season.
 Grass
 Preparation
 • Areas to be sprayed out with glyphosate herbicide and cultivated to a depth of 100mm removing all weeds, debris and stones over 25mm diameter. Surface to be raked to smooth following contours. Amenity grass to receive pre-seeding fertiliser at 70g/m².
 • Minimum overall recommended rooting depth is 450mm. First 150mm to be made up of multi-purpose topsoil and the remainder with suitable subsoil. All stones and other large objects over 50mm to be removed from the prepared surface.
 Seeding
 • Grass to be sown either in April/May or September/October during calm weather. Seed shall be sown in two equal sowings in transverse directions at 35 g/m² for amenity grass. After sowing the contractor shall lightly rake the seed into intimate contact with the soil.
 Initial Cut
 • When newly seeded grass reaches height of 50mm it should be lightly rolled and cut to a height of 25mm.

KEY TO LANDSCAPING :

- EXISTING HEDGEROWS
- EXISTING TREES
- PROPOSED HEDGEROWS: All new hedgerows to comprise 50% hazel & mix of crab apple, holly, oak & buckthorn. *see planting schedule below*
- EXISTING HEDGEROWS
- PROPOSED TREE PLANTING: *see tree planting schedule below*
- PROPOSED FENCE LINES: 1.8m High Close Boarded Timber
- PROPOSED REPTILE HIBERNACULA

KEY TO HOUSING :

HOUSE TYPE	TOTAL NUMBER	STOREYS & BEDROOMS	FOOTPRINT DIMENSIONS
B-BEHM	15	2 ST 0R	10.8m x 10.1m
C-CLYDACH	22	2.5 ST 0R	10.8m x 8.4m
D-DILAB	5	2.5 ST 0R	9.6m x 5.1m
G-GOVENRMETH	9	2 ST 4B	10.1m x 8.0m
M-MORLAB Aff: Affordable House	16	2 ST 0R	9.7m x 9.0m
TOTAL	71		

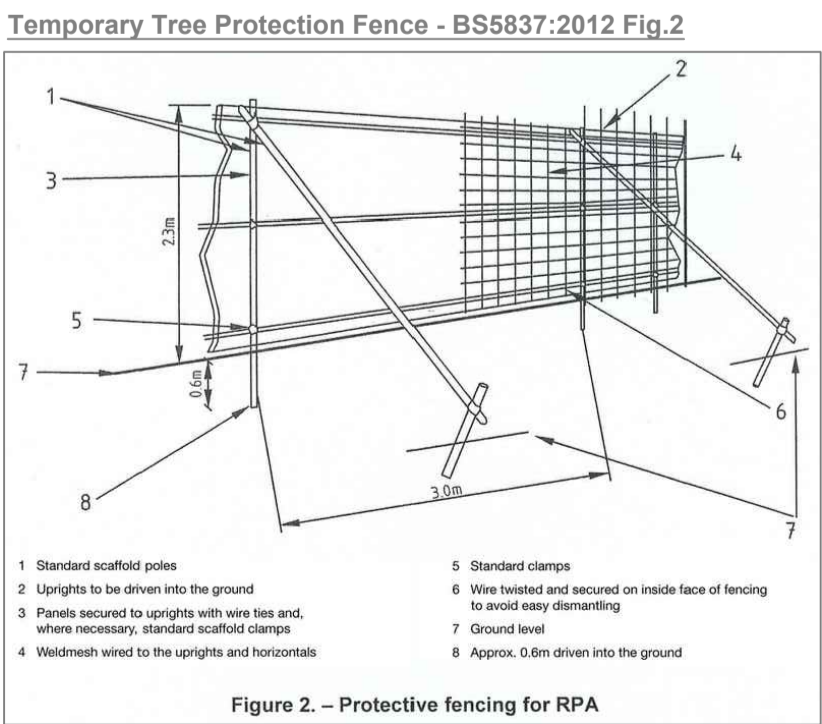
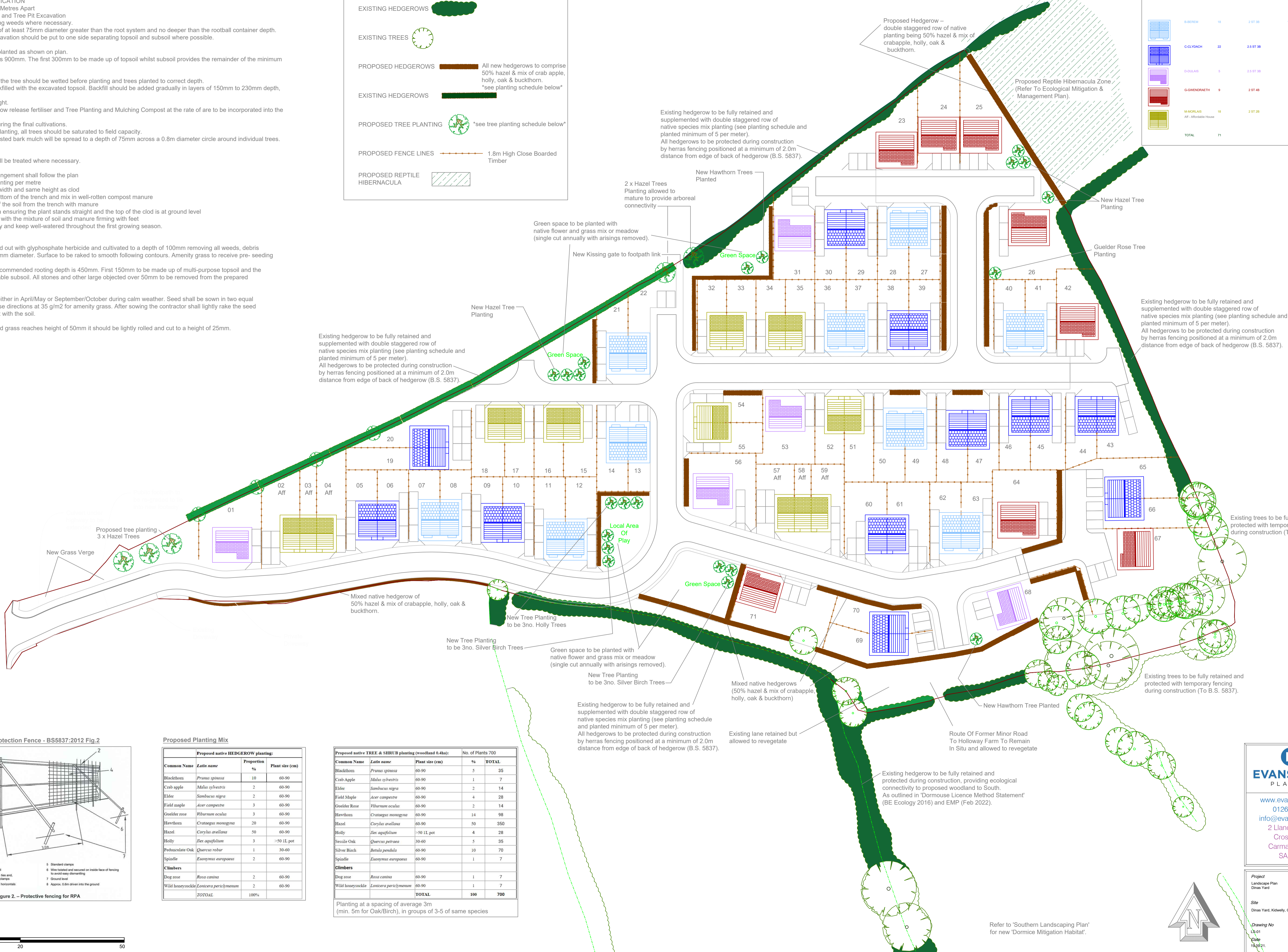

Proposed Planting Mix

Common Name	Latin name	Proportion %	Plant size (cm)
Blackthorn	<i>Prunus spinosa</i>	10	60-90
Crab apple	<i>Malus sylvestris</i>	2	60-90
Elder	<i>Sambucus nigra</i>	2	60-90
Field maple	<i>Acer campestre</i>	3	60-90
Guelder rose	<i>Viburnum opulus</i>	3	60-90
Hawthorn	<i>Crataegus monogyna</i>	20	60-90
Hazel	<i>Corylus avellana</i>	50	60-90
Holly	<i>Ilex aquifolium</i>	3	>50 LL pot
Pedunculate Oak	<i>Quercus robur</i>	1	30-60
Spindle	<i>Euonymus europaeus</i>	2	60-90
Climbers			
Dog rose	<i>Rosa canina</i>	2	60-90
Wild honeysuckle	<i>Lonicera periclymenum</i>	2	60-90
TOTAL		100%	

Proposed native TREE & SHRUB planting (woodland 0.4ha)

Common Name	Latin name	Plant size (cm)	%	TOTAL
Blackthorn	<i>Prunus spinosa</i>	60-90	5	35
Crab Apple	<i>Malus sylvestris</i>	60-90	1	7
Elder	<i>Sambucus nigra</i>	60-90	2	14
Field Maple	<i>Acer campestre</i>	60-90	4	28
Guelder Rose	<i>Viburnum opulus</i>	60-90	2	14
Hawthorn	<i>Crataegus monogyna</i>	60-90	14	98
Hazel	<i>Corylus avellana</i>	60-90	50	350
Holly	<i>Ilex aquifolium</i>	>50 LL pot	4	28
Sessile Oak	<i>Quercus petraea</i>	30-60	5	35
Silver Birch	<i>Betula pendula</i>	60-90	10	70
Spindle	<i>Euonymus europaeus</i>	60-90	1	7
Climbers				
Dog rose	<i>Rosa canina</i>	60-90	1	7
Wild honeysuckle	<i>Lonicera periclymenum</i>	60-90	1	7
TOTAL			100	700

Planting at a spacing of average 3m (min. 5m for Oak/Birch), in groups of 3-5 of same species

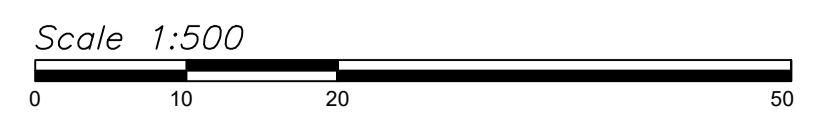

EB EVANSBANKS PLANNING

www.evansbanks.com
 01269 400410
 info@evansbanks.com
 2 Llandeilo Road,
 Cross Hands,
 Carmarthenshire,
 SA14 6NA

Project: Dinas Yard, Kidwelly, Carmarthenshire.
 Drawing No: LK/01
 Date: 13/08/21
 Revision: G: 01.04.22
 Scale: 1:500 @ A1

Refer to 'Southern Landscaping Plan' for new 'Dormice Mitigation Habitat'.