

Proposal to reconfigure nursery provision in Ammanford town area

Consultation Document



sirgar.llyw.cymru
carmarthenshire.gov.wales

Cyngor Sir Gâr
Carmarthenshire
County Council



Contents

Introduction	4
Schools Subject to Proposals	5
The Consultation Process	7
Background	12
The Proposals	14
1. The Proposal Ammanford Nursery	14
Quality and standards in education	17
Need for places and the impact on accessibility of schools	19
Resourcing of education and other financial implications.....	21
Other general Factors	21
Specific Factors in the Consideration of School Closures	22
Community Impact Assessment.....	23
Integrated Impact Assessment.....	25
2. The Proposal Ysgol Bro Banw	25
Specific factors where proposals concern adding nursery classes.....	28
Quality and standards in education	30
Need for places and the impact on accessibility of schools	33
Resourcing of education and other financial implications.....	34
Other general Factors	35
Admissions Arrangements.....	36
Integrated Impact Assessment.....	37
3. The Proposal Ysgol Gymraeg Rhydaman	37
Specific factors where proposals concern adding nursery classes.....	40
Quality and standards in education	42
Need for places and the impact on accessibility of schools	45
Resourcing of education and other financial implications.....	46
Other general Factors	46
Admissions Arrangements.....	47
Integrated Impact Assessment.....	48
School(s) likely to be affected by this proposal	49
Appendix A – Response Form.....	52
Appendix B - Welsh Language Impact Assessment – Ammanford Nursery	59

Appendix C - Welsh Language Impact Assessment – Ysgol Bro Banw	70
Appendix D - Welsh Language Impact Assessment Ysgol Gymraeg Rhydaman	80

Introduction

This consultation document outlines the Local Authority's proposal to reconfigure nursery provision in Ammanford town from September 2026 by:

1. Discontinuing Ammanford Nursery School

Whilst also,

2. extending the age range at Ysgol Bro Banw from 4-11 to 3-11
3. extending the age range at Ysgol Gymraeg Rhydaman from 4-11 to 3-11

to accommodate pupils from Ammanford nursery school

Should proposals regarding point 1 proceed all former Ammanford nursery pupils would continue to receive their education on a part time basis under the governance of Ysgol Bro Banw and Ysgol Gymraeg Rhydaman or an alternative school based on parental preference and following the published school admission process

The document offers an opportunity for consultees to put forward any comments, observations or alternative options they wish to be considered.

The Consultation Period for the proposals will take place from 4/9/25 to 16/10/25. Any responses received after this date will not be considered as part of the consultation process.

Consultation will follow the guidelines established by the Welsh Government (WG) as stated in the [School Organisation Code \(2018\)](#).

Schools Subject to Proposals

		Ysgol Bro Banw	Ysgol Gymraeg Rhydaman	Ammanford Nursery
School Location		Infants Walters Road Ammanford SA18 2NF Juniors High Street Ammanford SA18 2NS	Lon yr Ysgol Ammanford, SA18 2NS	High Street Ammanford SA18 2NS
Age Range		4-11	4-11	3-5
School Category (Community [C], Voluntary Aided [VA], Voluntary Controlled [VC])		Community Primary	Community Primary	Nursery School
Language Category		3.1 3= Welsh medium (3 classes) 1=English Medium (14 classes)	3 (Welsh Medium)	2 Dual Language
Number of registered Pupils (PLASC 2025) * **Total excludes ALN Unit pupils Y Bro Banw	Nursery Age	14	22	81
	Reception – Y.6	371	266	N/A
	Total	385*	288	81
Number of pupils previously on the register (including nursery PLASC)	Jan 2024	389	288	103
	Jan 2023	428	287	90
	Feb 2022	428	292	87
	April 2021	434	298	111
Pupil Projections (excluding nursery) (2025)	January 2026	367	251	N/A
	January 2027	355	250	N/A
	January 2028	341	247	N/A
	January 2029	335	255	N/A
	January 2030	336	253	N/A
Nursery Capacity 24/25		28	22	95
Reception-Y6 Capacity 24/25		495	210	-
Total Capacity 24/25		523	232	95
Nursery Capacity 25/26		25	16	95
Reception-Y6 Capacity 25/26		450	258	-
Total Capacity 25/26		475	274	95
Cost per pupil (2024/25)		£7,292	£4,260	£4,803
School Budget (2024/25)		£3,281k	£1,227k	£495k
Estyn Inspection Result		Inspection Report Ysgol	Inspection report Ysgol	Inspection report Ammanford

	Bro Banw 2024 www.estyn.gov .wales	Gymraeg Rhydaman 2024 www.estyn.gov. wales	Nursery School 2017 www.estyn.gov. wales
Building Condition Category (2024)	B	B	B

(PLASC) – Pupil Level Annual School Census

Condition	
Grade A	As new condition
Grade B	Sound, operationally safe, and exhibiting only minor deterioration
Grade C	Operational but major repair or replacement needed in short to medium-term
Grade D	Inoperable or serious risk of major failure or breakdown

The Consultation Process

The consultation on the proposals within this consultation document will follow guidelines established by the Welsh Government as stated in the School Organisation Code (2018).

Who will be consulted?

A link to the Consultation Document will be provided to the following stakeholders (as determined by the School Organisation Code (2018)):

- *Parents (and where possible prospective parents) carers and guardians, and staff members of schools affected by the proposals;*
- *in the case of proposals affecting secondary provision, parents of pupils attending primary schools from which pupils normally transfer to that secondary school;*
- *the maintaining or proposed maintaining authority for any school likely to be affected by the proposals;*
- *any other local authority (including those in England, where appropriate) likely to be affected - including in the case of dedicated SEN provision any authority placing or likely to place pupils with SEN in it;*
- *the Church in Wales and Roman Catholic Diocesan Authority for the area in which any school likely to be affected is located;*
- *any other appropriate religious body for any school likely to be affected by the proposals;*
- *the governing body of any school which is the subject of the proposals;*
- *the governing body of other schools which the proposer consider are likely to be affected by the proposals;*
- *the Welsh Ministers;*
- *Constituency and Regional Assembly Members (AMs) and Members of Parliament (MPs) representing the area served by/intended to be served by any school which is the subject of the proposals;*
- *Estyn;*
- *teaching and staff trade unions representing teachers and other staff at any school which is the subject of the proposals;*
- *the relevant Regional Education Consortium;*
- *the Police and Crime Commissioner for the area served by/intended to be served by any school which is the subject of the proposals;*
- *any community or town council for the area served by/ intended to be served by any school which is the subject of the proposals;*
- *in the case of proposals affecting nursery provision any independent or voluntary providers who may be affected including Mudiad Meithrin;*
- *in the case of proposals affecting nursery provision, the Children and Young People's Partnership and/or the Early Years Development and Childcare Partnerships where present;*
- *in the case of proposals affecting SEN provision, any relevant health or third sector bodies with an interest;*

- *in the case of proposals affecting secondary provision, any further education institutions serving the area of the school; and*
- *in the case of proposals affecting Welsh language provision, the Welsh Language Commissioner.*

Consultation with Pupils

Pupils will be provided with a copy of a Children and Young People Consultation Document.

Additionally, there will be an opportunity for the pupils (School Council as a minimum) of the schools subject to the proposals to participate in the consultation process during a session which will be undertaken by an Education Support Advisor.

The information gathered from the consultation with pupils will form part of the Consultation Report which will be submitted to the Cabinet for consideration following the consultation period.

What happens next?

Stage 1. Consultation Period

The consultation period for the proposals starts on 4/9/25 and ends on 16/10/25.

You can submit your views in favour of or against a proposal or to provide alternative suggestions. Responses received during the consultation period will not be treated as statutory objections. If you wish to object, you will need to do so in writing during the statutory objection period. Any responses received after the closing date will not be considered as part of the consultation process.

Considering your views

During the consultation period you can ask questions, express your views or provide alternative options for consideration by no later than 16/10/25 through one of the following methods:

- Completing an online survey using the following link: [SNAP SURVEY](#)
- Sending an email to: MEPConsultations@carmarthenshire.gov.uk
- Writing a letter to the following address: Mr Owain Lloyd, Director of Education and Children's Services, County Hall, Carmarthen, Carmarthenshire, SA31 1JP
- Or completing a paper copy response for (Appendix A) and returning to Mr Owain Lloyd, Director of Education and Children's Services, County

Hall, Carmarthen, Carmarthenshire, SA31 1JP or by sending a scanned copy via e-mail to MEPConsultations@carmarthenshire.gov.uk

Please note that you only need to submit your response through **one** communication method only.

Comments submitted during the consultation period will be recorded and summarised in a Consultation Report.

Following the consultation period, a Consultation Report will be published on Carmarthenshire County Council's website at least 2 weeks prior to the publication of a Statutory Notice.

The Cabinet of Carmarthenshire County Council will consider the Consultation Report and decide whether or not to proceed with the proposal.

Stage 2. Statutory Notice Objection Period

If the Cabinet decides to continue with the proposal Carmarthenshire County Council must publish a document known as a "Statutory Notice".

The Statutory Notice will be published on Carmarthenshire County Council's website and posted at the schools subject to proposals. Copies of the notice will also be made available to the schools to distribute to pupils, parents, guardians, and staff members (the schools may also distribute the notice by email).

The Statutory Notice will set out the details of the proposal and invite anyone who wishes to object or support to do so in writing within a period of 28 days.

If objections are received an Objection Report will be published on Carmarthenshire County Council's website. Hard copies of the report will also be available on request. The report will summarise the issues or supportive comments raised and provide Carmarthenshire County Council's response.

If no objections are received, the proposal moves straight to determination.

Stage 3. Determination

Carmarthenshire County Council will determine the proposal. This means that it will make a final decision on whether the change proposed goes ahead. The County Council may decide to approve, reject or approve the proposal with modifications. In doing so, the County Council will take into account any statutory objections that it received.

Following determination of proposals all interested parties will be informed and advised of the availability of the decision which will be published electronically on Carmarthenshire County Council's website.

All stakeholders will be notified of the County Council decision and publication of the Objection Report within 7 days of the determination.

Statutory Process Timeline

An indicative statutory process timeline is shown below:

Stage	Description	Duration
1	Consultation Issue of this consultation document to identified and other interested parties.	September 2025 – October 2025 At least 42 days (including at least 20 school days)
2	Consultation Report A Consultation Report will be taken to the Cabinet for a decision on whether or not to proceed to publish a statutory notice. OR alternatively proposal ends.	January 2026 The Consultation Report will be published on Carmarthenshire County Council's website at least 2 weeks prior to the publication of a statutory notice
3	Statutory Notice If the decision is made to proceed then a statutory notice will be published. The notice will outline details of the proposal and be published on the Council's web site and be displayed near the entrance of the school and schools which are subject to the proposals. Copies of the notice will be made available to the school to distribute to parents, guardians and staff members. The statutory notice will give details on how you may record your objections to the proposal.	February – March 2026 Minimum 28 days (including at least 15 school days & not including the day of publication)

4	<p>Objection Report</p> <p>If objections are received an Objection Report will be published on the Carmarthenshire County Council's website. Hard copies of the report will also be available on request. The report will summarise the issues or supportive comments raised and provide Carmarthenshire County Council's response.</p> <p>If no objections are received, the proposal moves straight to determination.</p>	<p>June 2026</p> <p>Before the end of 7 days beginning with the day of its determination</p>
5	<p>Determination</p> <p>County Council will determine the proposal. The County Council may decide to approve, reject or approve the proposal with modifications, in doing so the County Council will take into account any statutory objections received.</p> <p>Following determination of proposals all interested parties will be informed and advised of the availability of the decision which will be published electronically on Carmarthenshire County Council's website.</p>	<p>June 2026</p> <p>Decision made within 16 weeks of the end of the objection period</p>

Background

The proposal to reconfigure nursery provision in the Ammanford town area has been prepared in response to the Council's Cabinet decision to remove Carmarthenshire's Rising 4s Policy, whereby children were historically eligible to enter full-time primary education at the start of the school term in which they turned four years of age.

Following a period of public consultation held between 19 January 2024 and 1 March 2024, the Council's Cabinet resolved on 25 March 2024 to remove Carmarthenshire's Rising 4s Policy, which means that, as of 1 September 2025, children will be eligible for full-time school at the start of the term **following their fourth birthday**. From this date, there will be no children in full-time reception class provision who are three years of age.

Children who have turned three are eligible for a minimum of 10 hours per week of non-statutory approved education provision delivered on a part-time sessional basis, either in one of the county's 42 primary schools which are designated as age 3-11 schools and where this provision is maintained by the Council, or a minimum of 10 hours education in approved non-maintained settings such as day nurseries or Cylchoedd Meithrin. Working parents of eligible 3 to 4 year olds are able to access up to 30 hours funded combined childcare and education via the Welsh Government's Childcare Offer.

One impact of the removal of the Rising 4s Policy is that children will remain in nursery provision and childcare settings for a term longer than previously. In the short term, this might create an additional demand for provision of non-statutory education for a greater number of three-year-old children, and possibly an increased demand for wrap-around care. Ideally, this demand will be met by the non-maintained sector where providers will be able to expand provision to cater for additional numbers of children for either or both of the minimum 10 hours education and for wrap around care.

In communities where this does not happen and where gaps in provision of the education element exist, the Council proposes changes to some of its 4-11 schools to 3-11 schools. This would enable these schools to deliver the minimum of 10 hours non-statutory early years education element and provide greater equity of provision across Carmarthenshire. A 3-11 school receives delegated funding for the provision of 3-year-old education on a part-time basis by the Council.

Currently, a small number of children in the Ammanford area receive their non statutory early years education at Ammanford Nursery School, which is the only maintained nursery school in the county. Children are admitted to the 3 to 5 age range school in the term following their third birthday, and are currently able to attend full time, although this is due to change to part time provision only from January 2026. All other nursery provision in maintained schools throughout Carmarthenshire is on a part time basis.

From September 2025, pupils would have the option of transfer to a full-time primary school place at the beginning of the term following the child's 4th birthday, however

parents can choose to keep their children in the nursery until they reach compulsory school age of 5 before transferring to a primary school.

Historically in the main parents have chosen to send their children from Ammanford Nursery to either Ysgol Bro Banw or Ysgol Gymraeg Rhydaman or other schools in the area. By discontinuing Ammanford Nursery and increasing the age range of Ysgol Bro Banw and Ysgol Gymraeg Rhydaman this would provide both schools equity with other 3-11 primary schools in Carmarthenshire providing part time nursery provision.

The Proposals

These proposals are considered under section 2.1 and 2.3 of the School Organisation Code (2018). Section 2.1 refers to the closing of a maintained school. Section 2.3 refers to regulated alterations of a school, which includes changing the age range of a school by a year or more.

Location of Schools subject to the proposals



1. The Proposal Ammanford Nursery

The Proposal

The proposal is to discontinue provision at Ammanford Nursery.

Current Arrangements – Status Quo

Ammanford Nursery is a 3-5 Dual Stream (category 2) Nursery School located in the town of Ammanford within a mixed commercial and residential area and is the only school of its kind in Carmarthenshire. The school occupies a wing in Ysgol Bro Banw's (Junior unit) and shares the adjoining kitchen and dining facilities. It is located in close proximity to Ysgol Gymraeg Rhydaman with which it also shares the kitchen/dining facilities. The school provides education through the medium of Welsh or English in two separate streams and is therefore listed as in the linguistic category of Dual Stream (DS). The school currently has 81 pupils on roll (PLASC 2025) and has capacity for the academic year 25/26 of 95. To date Ammanford Nursery has offered nursery education on a full-time basis which is different to all other school-based

nursery provision in Carmarthenshire. As of January 2026, this provision is only on a part time basis.

There are various types of early years provision available across Carmarthenshire:

- 1 Nursery school (Ammanford)
- Nursery / Early Years Classes in 3-11 primary schools
- Provision by the non-maintained sector who are partners in the Early Entitlement Group, such as Early Years Wales, Mudiad Meithrin (MM) and private providers.

The catchment area for Ammanford Nursery is the same as that for Ysgol Bro Banw and Ysgol Gymraeg Rhydaman. Historically, most Nursery pupils in the English stream have transferred to Ysgol Bro Banw whilst pupils from the Welsh stream have transferred, in the main, to either Ysgol Gymraeg Rhydaman or Ysgol Bro Banw. Around a third have transferred to other neighbouring schools in Ammanford and beyond.

Strengths of the Status Quo

- No change for staff, pupils and the wider community
- No statutory procedures needed
- Small school ethos

Weaknesses of the status quo

- Lack of continuity in Education transitioning from a standalone nursery to a primary school when compared with a 3-11 primary school
- Limited professional development and collaboration for staff in a standalone nursery
- Limited resources and funding when compared to a larger primary school
- Parents choosing to attend full time nursery potentially impacting on neighbouring schools and external providers who offer part time education provision

Rationale for change

In line with Council's Cabinet decision to remove Carmarthenshire's Rising 4s Policy in March 2024 this provided an opportunity to review nursery provision in the area to achieve a consistent approach across the county.

Transition Period

Should the proposals proceed, the Council will provide full support to the staff and governors of all schools affected by these proposals throughout the transition period. The alternative provision will be located at:

Ysgol Bro Banw, Walters Road & High Street, Ammanford, SA18 2NF

Ysgol Gymraeg Rhydaman, Lon yr Ysgol, Ammanford, SA18 2NS

Benefits and Disadvantages of the proposal

The expected benefits of the proposals and disadvantages when compared with the status quo.

Benefits	Disadvantages
Gradual and supported transition for 3-year-olds entering school, starting with half days and progressing to full school days.	Change for staff, pupils and families relying on full time provision for working/caring purposes having to make alternative arrangements.
Potential for employment at alternative schools, Ysgol Bro Banw and Ysgol Gymraeg Rhydaman.	Loss of small school ethos with pupils having to adjust to a larger school environment
Standardisation of nursery provision in Ammanford town area in line with other 3-11 schools in Carmarthenshire.	
The removal of LA full-time provision for 3-year-olds in the Ammanford area will provide an opportunity for private childcare providers who offer wrap around care.	

Risk Management

Risks associated with the proposals and any measures required to manage these;

Risk		Risk Management
1.	Failure to obtain statutory approval to implement the proposal	Follow guidelines set out in the School Organisation Code 2018
2.	Integration of pupils into the proposed alternative school(s)	The authority will work with the school community and pupils to ensure smooth transition and integration into the school.

Alternative Options considered

A range of alternatives options have been considered as part of the proposals within this consultation document including reasons why some have been discounted.

Alternative Option	Description	Reason for discounting
Option 1	Status Quo no change to Ammanford Nursery	Does not align with recent County Council's Cabinet decision to remove Carmarthenshire's Rising 4s Policy and equity of provision throughout Carmarthenshire's 3-

		11 schools. Ammanford Nursery is the only stand alone nursery school in Carmarthenshire providing full time education.
Option 2	Ammanford Nursery to offer nursery provision to both Ysgol Bro Banw and Ysgol Gymraeg Rhydaman	Missed opportunity to align Ysgol Bro Banw and Ysgol Gymraeg Rhydaman to other 3-11 schools in Carmarthenshire in line with County Council's aspirations.
Option 3	Ysgol Bro Banw and Ysgol Gymraeg Rhydaman become 3-11 schools. Ammanford Nursery building remains feeding both schools	There is sufficient building capacity in Ysgol Bro Banw.

Learner Travel Arrangements

To qualify for free transport pupils must meet a number of criteria as outlined in [Carmarthenshire County Council - School Transport Policy](#), one of which is that pupils are of compulsory school age. As the provision of early years education is for pupils under compulsory school age, free transport would not be available for pupils therefore the proposal does not have any associated transport costs.

Nursery provision would continue to be provided from the existing Ammanford Nursery building to accommodate part time nursery pupils should proposals proceed. There are therefore no envisaged transport implications for learner travel arrangements.

Quality and standards in education

The School Organisation Code (2018) requires an analysis of the likely impact of the proposals on the quality and standards of education in the school, taking into account the relevant Estyn inspection areas, which are outlined in the following section.

Current school priorities / Estyn recommendations:

Ammanford Nursery was last inspected by Estyn in November 2017 and currently is in "No Follow Up". This means that the school has met the required standards of the inspection and does not require any additional monitoring or intervention from Estyn.

Estyn Recommendations from 2017:

- R1 - Plan a better balance between formal and informal activities in order to give children more freedom to be creative when making decisions about their learning
- R2 - Refine procedures for assessing and tracking children's progress
- R3 - Provide more natural opportunities for children to practice their free writing skills independently across the learning areas

Current school priorities:

- To embed a whole school approach to emotional and mental wellbeing, ensuring the needs and wellbeing of all individuals are met appropriately.
- To continue to promote the importance of attendance across the school community by delivering pastoral support systems to tackle persistent absence.
- To further develop assessment to include more detailed vulnerability assessment profiling
- To further develop parental engagements in order for them to support their child's development

The likely impact of the proposals on Ammanford Nursery:

The likely impact of the proposal to discontinue Ammanford Nursery and transfer its pupils with their peers to a 3 – 11 primary school, where they would be likely to have access to a wider range of experiences due to being in a 3 – 11 school.

Learning - standards and progress overall:

- There is no potential impact on the development of skills as the provision for skill development is good in all schools.
- It is noted in all inspection reports that most pupils, including those eligible for free school meals, those with additional learning needs and those who have English as an additional language, make strong progress in developing their skills, knowledge and understanding from their starting points.
- The Council's view is that Ysgol Bro Banw and Ysgol Gymraeg Rhydaman would provide education for pupils which is of at least equivalent quality or better than that provided at Ammanford Nursery, so were it to proceed, it is not anticipated that, the proposal would have a negative impact on standards and progress overall.

Wellbeing and attitudes to learning:

- Should the proposals proceed, there is no potential impact on pupils' wellbeing as they will remain with their peers within an area, they are already familiar with.
- It is noted in all inspection reports that nearly all pupils have a secure understanding of how to keep safe, healthy, and they feel safe at school. Nearly all children relate well to one another and adults and acquire a good range of personal and social skills, there is a genuine respect that all pupils show towards their peers, adults and others.
- Pupils behave well during lessons and around the school across all schools

Teaching and learning experiences:

- There is no potential negative impact as the breadth, balance and appropriateness of the curriculum across Ysgol Bro Banw and Ysgol Gymraeg Rhydaman is very effective.
- Teachers across the schools' plan in detail and provide a range of rich learning experiences that engage and stimulate pupils' interest.
- Should the proposals proceed, this proposal would ensure a greater pool of staff to share expertise to enhance the curriculum design provision.

- Should the proposals proceed, the proposal would facilitate a consistent uninterrupted education. Therefore, minimising the potential for disruption during transition from nursery to primary.

Care, support and guidance:

- There is no potential impact on pupils' care, support and wellbeing as all three schools are safe and secure. The schools are inclusive and caring where pupils have a strong sense of belonging.
- The schools' have robust processes in order to identify pupils with additional needs at an early stage. The staff across the schools' provide purposeful support programs that are effective in responding to pupils' needs, constantly tracking their progress.
- Should the proposals proceed it is not anticipated that the proposal will have a negative impact on vulnerable pupils as both schools ensure effective provision for all learners, with Bro Banw having specialist teaching provision classes, and provide exemplary care, support and guidance for all pupils, particularly for those with ALN.

Leadership and management:

- Currently Ammanford Nursery doesn't have permanent leadership. There is an acting head teacher on site for three days per week following the retirement of the previous head teacher. Financial restraint doesn't allow the school to recruit for a full-time non-teaching head teacher. Should proposals proceed it would ensure that all pupils have a permanent full time head teacher on site.
- It is not anticipated that the implementation of the proposal, if adopted , would impact on the development of National priorities or professional learning opportunities for staff as effective monitoring processes ensure that leaders, staff and members of the governing body are all involved in evaluating the school's work and supporting staff to identify personal professional learning needs alongside the school's priorities for improvement across all schools.
- If adopted , the proposal will lead to an increase in pupil numbers across three sites rather than across the current four sites, therefore will have a positive effect on the efficient use of resources to contribute to a sustainable future for Ysgol Bro Banw and Ysgol Gymraeg Rhydaman.

Need for places and the impact on accessibility of schools

The School Organisation Code (2018) requires relevant bodies to take into account the following points in relation to the need for places and impact on accessibility of schools:

- ***Whether alternative school-based provision will have sufficient capacity and provide accommodation of at least equivalent quality, for existing and projected pupil numbers***

The preferred option is for pupils to be accommodated at:

Ysgol Bro Banw, Walters Road & High Street, Ammanford, SA18 2NF
Ysgol Gymraeg Rhydaman, Lon yr Ysgol, Ammanford, SA18 2NS

There is sufficient capacity at Ysgol Bro Banw (infants site) to accommodate the additional nursery pupils.

The former building of Ammanford Nursery will be utilised for the additional capacity required at Ysgol Gymraeg Rhydaman.

Ysgol Bro Banw is rated as B for building condition and Ysgol Gymraeg Rhydaman is rated as B for building condition which means that the standard of accommodation at both schools is at least equivalent to Ammanford Nursery (B building condition).

- ***Is the alternative school-based provision sufficient to meet existing and projected demand for schools of the same language category as set out in “Defining schools according to Welsh medium provision” Welsh Assembly Government Information document No: 023/2007 or any successor documents; and***

Ysgol Bro Banw is a dual stream school (category 3.1) and:

Ysgol Gymraeg Rhydaman is a Welsh medium school (category 3)

Both schools will have sufficient capacity to accommodate nursery pupils (current and projected numbers) from Ammanford Nursery – Ysgol Bro Banw will accommodate nursery pupils on their Infant Site and Ysgol Gymraeg Rhydaman would utilise the current Ammanford Nursery building which is located next door.

- ***The extent to which the proposal would support the targets in the approved Welsh in Education Strategic Plan (WESP).***

Carmarthenshire’s Welsh in Education Strategic Plan (WESP) 2022 - 2032 aims to facilitate an increase in the number of people of all ages able to use the Welsh language with their families, in their communities and in the workplace.

This proposal would offer Welsh medium nursery education for three-year-olds at both Ysgol Gymraeg Rhydaman and Ysgol Bro Banw and would strengthen the transition between Welsh medium nursery provision and primary education in the Ammanford town area.

- ***How the proposal would expand or reduce Welsh language provision***

Should the proposals proceed, it would ensure access to Welsh language Early Years provision for the Ammanford town area at both Ysgol Gymraeg Rhydaman and Ysgol Bro Banw. There will be no reduction in Welsh language provision.

An initial Welsh Language Assessment has been undertaken and is attached to this document at Appendix B. This assessment will be reviewed and updated at key points should the proposal proceed.

- ***The nature of journeys to alternative provision and resulting journey times for pupils including SEN pupils;***

There will be little or no impact on journey times. As can be seen from the location of schools subject to the proposals aerial photograph noted earlier in this document, all schools are within half a mile of each other.

- ***Whether proposals will improve access for disabled pupils in accordance with requirements under the Equality Act 2010***

The school has an accessibility plan. However, should a pupil require any adaptations to the school, reasonable adjustments will be made for the pupil in line with established Carmarthenshire County Council School Organisation processes.

Resourcing of education and other financial implications

The School Organisation Code (2018) requires relevant bodies to take into account the following points in relation resourcing of education and other financial implications:

- ***What effect proposals will have on surplus places in the area***

Should the proposals proceed, it is anticipated that the proposal would have a positive impact on reducing surplus places in the area.

- ***The recurrent costs of proposals over a period of at least 3 years and whether the necessary recurrent funding is available***

N/A

- ***additional transport costs incurred as a result of proposals;***

No additional transport costs.

- ***the scale of any projected net savings (taking into account school revenue, transport and capital costs);***

A revenue saving of approximately £180k (pupil number funding) will be realised from January 2026 due to the change from full time to part time provision.

Other general Factors

The School Organisation Code (2018) requires relevant bodies to take into account the following points in relation to other general factors:

- ***Impact of the proposal will have on educational attainment among children from economically deprived backgrounds***

The above proposal would not likely have a negative impact on vulnerable groups of learners including those from economically deprived backgrounds or learners with additional learning needs as there would be a greater team of staff and resources to support learners within a larger school. Transition meetings and strong communication will take place prior to the move. Any vulnerable learners needing additional support have access to external agencies and LA officer advice.

- ***Equality issues, including those identified through equality impact assessments***

There are no apparent equality issues identified through the Integrated Impact Assessment at this stage. The Integrated Impact Assessment does not highlight any disproportionate impact on any of the protected characteristics. Should the proposal proceed, the Integrated Impact Assessment will be reviewed and updated at key points as necessary.

Specific Factors in the Consideration of School Closures

- ***Whether the establishment of multi-site schools might be considered as a means of retaining buildings, or the reasons for not pursuing this option***

A range of options have been considered as outlined within this document as well as a reason for discounting each option. The preferred option will align with County Council aspirations for equal 3-11 provision across Carmarthenshire.

- ***Whether alternatives to closure, such as clustering, collaboration or federation with other schools, might be considered (taking into account the scope for use of ICT links between school sites) or the reasons for not pursuing these as an alternative***

In deciding on a preferred option, the former buildings of Ammanford Nursery would be utilised for the nursery provision at Ysgol Gymraeg Rhydaman located adjacent to the existing school.

- ***Whether the possibility of making fuller use of the existing buildings as a community or educational resource could be explored***

As noted above, should the proposal proceed, it is intended that the buildings of the current Ammanford Nursery school will be used to accommodate the nursery expansion at Ysgol Gymraeg Rhydaman.

- ***The overall effect of closure on the local community (including the loss of school based facilities which are used by the local community)***

Ammanford nursery provides a breakfast club and after school club, the school is not used for any other services.

A community impact assessment has been completed with input from the school which will be presented and considered before a decision to approve or reject proposals is made.

- ***How parents' and pupils' engagement with the alternative school and any facilities it may offer could be supported***

Should proposals proceed parents and pupils will be supported through the transitional period as part of the transitional process ensuring full engagement with the alternative schools.

Community Impact Assessment

- ***Information on the proportion of pupils from the catchment area that attend the school;***

No data collected by the Local Authority for Ammanford Nursery catchment area.

- ***Information on the proportion of pupils from outside the catchment area that attend the school;***

No data collected by the Local Authority for Ammanford Nursery catchment area.

- ***Information about any other facilities the school accommodates e.g. youth club/play group;***

The school currently accommodate an after school provision Clwb Caleb run as a separate business through a lettings agreement. The nursery building is used between 3pm-5pm Monday to Friday.

- ***Information about any other facilities or services the school provides e.g. after school clubs, community library;***

Ammanford Nursery currently provides a breakfast club between 8-8.45am.

- ***If accommodation, facilities or services are provided by a school, where they would be provided in the event of closure;***

The alternative schools noted below offer a breakfast club and after school provision.

Ysgol Bro Banw, Walters Road & High Street, Ammanford, SA18 2NF

Ysgol Gymraeg Rhydaman, Lon yr Ysgol, Ammanford, SA18 2NS

- ***Whether other facilities available in the immediate local or wider community will or could be enhanced in the event of a school closure (e.g. improvements to village halls, playgrounds, provision of holiday play schemes);***

No change

- ***Information about the facilities and services provided at any alternative school;***

Ysgol Bro Banw and Ysgol Gymraeg Rhydaman both offer breakfast clubs and after school clubs comparable with what is offered at Ammanford Nursery School.

Ammanford Nursery is not used for any other services apart the breakfast club and after school club both of which are available at the alternative school(s).

- ***Information about the distance and travelling time involved in attending an alternative school of the same language category;***

No change

- ***How parents' and pupils' engagement with the alternative school and any facilities it may offer could be supported (e.g. how pupils (and particularly any less advantaged pupils) will be helped to participate in after school activities);***

Parental engagement with any alternative provisions and facilities would be supported through being in close proximity (walking distance, no travelling needed) and already established relationships.

- ***Impact on health and wellbeing e.g. if pupils would be less able to walk or cycle to school;***

No change – all schools subject to proposals within this consultation document are within close proximity of each other.

- ***Information about any wider implications the changes would have on public transport provisions;***

No change

- ***Information on wider community safety issues.***

No change

Integrated Impact Assessment

An integrated impact assessment (IIA) has been undertaken to help us to ensure we have considered how different groups and services could be affected by our proposals, enabling us to strengthen positive aspects and mitigate any potentially negative impacts.

The integrated impact assessment incorporates the requirements of the following Acts into one Impact Assessment:

- Well-being of Future Generations (Wales) Act 2015
- Public Sector Equality Duty and the Equality Act 2010
- Socio-Economic Duty 2021
- Welsh Language Measure 2011 and Welsh Language Standards
- United Nations Convention on the Rights of the Child (UNCRC) & Rights of Children and Young Persons (Wales) Measure 2011
- Environment (Wales) Act 2016 – biodiversity and ecosystem resilience

General Data Protection Regulation.

2. The Proposal Ysgol Bro Banw

The proposal is to change the age range of Ysgol Bro Banw from a 4-11 school to a 3-11 school from September, 2026.

Current Arrangements – Status Quo

Following the successful completion of statutory procedures in February 2008, the new Ysgol Bro Banw came into being at the start of the autumn term in September 2008 to replace the former Ammanford Junior School and Ammanford Infants School. Ysgol Bro Banw continues to operate on a split site utilising the buildings of the two former schools, which are approximately 0.5 mile apart. The school predominantly serves the town of Ammanford although it should be noted that a number of pupils from outside the traditional catchment area attend the school and special unit situated at the school. The Junior Unit of Ysgol Bro Banw is housed in a single storey structure built circa 1926. A section of the building is currently occupied by Ammanford Nursery School and to the rear of the building is located the kitchen and dining facilities which are also shared with Ammanford Nursery and Ysgol Gymraeg Rhydaman. The school also houses an ALN inclusion unit.

Ysgol Bro Banw is a 4-11 dual stream school (category 3.1) which does not currently offer part time non statutory 3-year-old early years education provision. This leads to a gap in the provision of education within the school between the age of 3 and 4.

Early years education is a non-statutory provision available to 3-year-olds. All 3-year-olds are entitled to a minimum 10 hours per week funded placement, at a registered setting, through the Early Entitlement Group from the term following their third birthday.

There are various types of early years provision available across Carmarthenshire:

- 1 Nursery school (Ammanford)
- Nursery / Early Years Classes in 3-11 primary schools
- Provision by the non maintained sector who are partners in the Early Entitlement Group, such as Early Years Wales, Mudiad Meithrin (MM) and private providers.

Early years education provision is currently provided at Ammanford Nursery school which, as can be seen by the image on page 14 is located in close proximity to Ysgol Bro Banw. Historically in the main parents have chosen to send their children from Ammanford Nursery to both Ysgol Bro Banw and Ysgol Gymraeg Rhydaman and other schools.

Current arrangements/status quo do not provide Ysgol Bro Banw with equitable early years education provision with other 3-11 schools in the county. By discontinuing Ammanford Nursery and increasing the age range of Ysgol Bro Banw this would provide equity with other 3-11 primary schools in Carmarthenshire and partially fill the gap in education provision created by the nursery closure.

Strengths of the Status Quo

- No change for staff, pupils and the wider community
- No statutory procedures needed

Weaknesses of the Status Quo

- The school does not offer equity of nursery education provision in line with other 3-11 schools in Carmarthenshire
- The school does not offer early years education provision on site
- Does not provide potential continuity of Education when compared with a 3-11 primary school
- Missed opportunity to immerse pupils in the Welsh Language at a younger age improving linguistic development (Welsh Stream)
- Does not offer equality with other 3-11 Welsh medium schools in Carmarthenshire (Welsh Stream)

Benefits to accessing early years education on a school site

- Early development of foundational skills
- Early identification of learning needs
- Early parental engagement
- Aids transition to primary and lifelong learning

Benefits and Disadvantages of the proposal:

Benefits	Disadvantages
Gradual and supported transition for 3-year-olds entering school, starting with half days and progressing to full school days.	Discontinuation of Ammanford Nursery.
Nursery provision available on the school site	Reduction in the demand for places at the privately-run nurseries and childminders who currently provide all day provision.
Benefits linguistic development of the Welsh Language at an earlier age (Welsh stream) in response to the Welsh in Education Strategic Plan with the Council and the Welsh Government ambition of reaching one million Welsh speakers by 2050	
Improve education standards for children in the area and significantly strengthen the transition from nursery to primary age pupils in the Welsh-medium sector (Welsh stream), offering continuity and uninterrupted progression to pupils	
Provides effective and sustainable provision to ensure progress in line with the requirements of Curriculum for Wales and in response to national standards and local policies	
May attract more pupils to attend the school	
Potential opportunity for employment at Ysgol Bro Banw	
Will attract additional pupil-led funding to the school	
Addresses the gap in 3-year-old early years Education in the Ammanford area	

Risk Management:

Risk		Risk Management
1.	Failure to obtain statutory approval to implement the proposal	Follow guidelines set out in the School Organisation Code 2018
2.	Effect on local economy through loss of numbers at private nursery providers	Consult with private providers openly regarding the proposal.
3.	The nursery class at the school does not receive sufficient applications	Number of applications cannot be predicted. This will be monitored by the admissions team.

Alternative Options considered:

Alternative Option	Description	Reason for discounting
Option 1	Status Quo no change to Ysgol Bro Banw	Does not align with County Council aspirations for 3-11 provision across Carmarthenshire.
Option 2	Provide early years provision at Neighbouring Schools	Pupils have to travel out of catchment to access non-statutory 3-year-old early years education provision at other schools. Pupils may not be admitted if there are capacity pressures at the schools.

Specific factors where proposals concern adding nursery classes

- ***The standard of nursery education and the sufficiency of accommodation and facilities offered, both in the classroom and outdoors, and the viability of any school that wishes to add nursery places.***

Should the proposal proceed, it is expected that extending the age range at Ysgol Bro Banw from 4–11 to 3–11, along with expanding its provision to include early years education, will fill the gap in provision created by the closure of Ammanford Nursery. In addition, this change will align the school with other 3-11 primary schools in Carmarthenshire. The introduction of early years education has the potential to increase pupils choosing to attend the school, further supporting the school's long-term sustainability.

Should the proposal to change the age range of Ysgol Bro Banw proceed the additional Nursery pupils will be accommodated in the area shown in floor plan below

and therefore the School Capacity and Admission number for the school would remain the same.

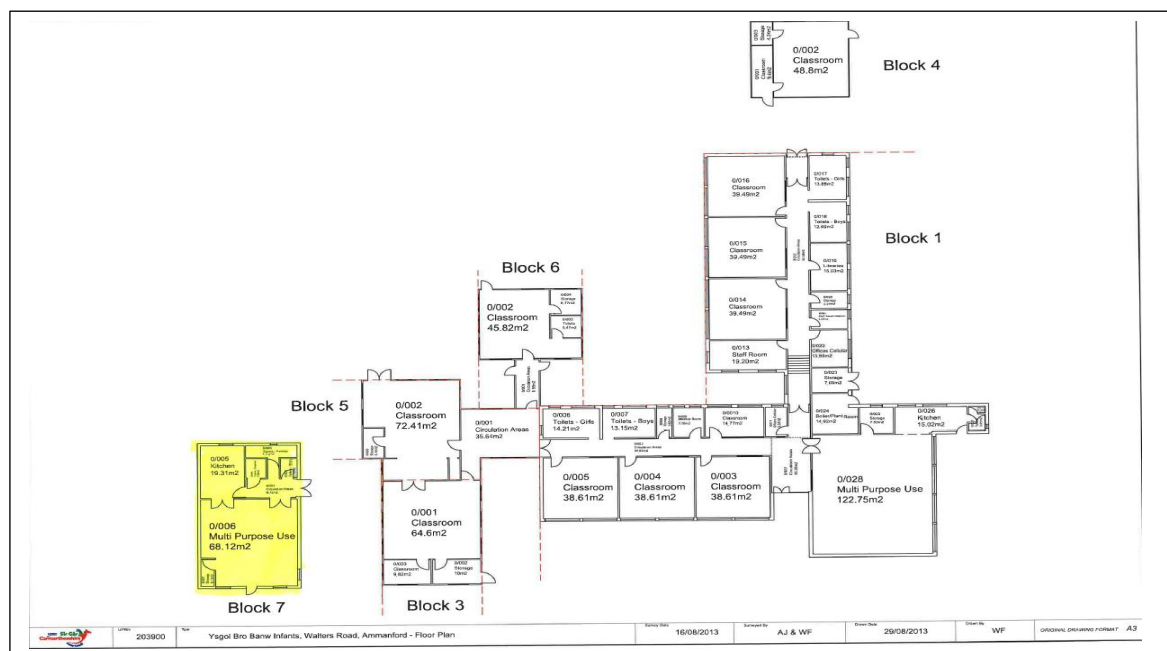

- ***Whether there is a need for additional nursery places in the area.***

Currently nursery places are provided at Ammanford Nursery school. Should this proposal proceed, it will replace the provision currently provided at Ammanford Nursery to ensure equitable access to early years education in line with other 3-11 primary schools in the county at Ysgol Bro Banw and Ysgol Gymraeg Rhydaman.

- ***The levels of demand for certain types of nursery education e.g. Welsh medium or provision with a religious character.***

Currently nursery places are provided at Ammanford Nursery school in both a Welsh and English stream. Should proposals proceed it will ensure equitable access to early years education with other 3-11 primary schools in the county in both languages at Ysgol Bro Banw and Ysgol Gymraeg Rhydaman.

- ***The effect of the proposals on other institutions, including private and third sector providers.***

In accordance with the School Organisation Code (2018), the Consultation Document will be shared with key stakeholders who may be impacted by the proposal, including, but not limited to:

- the maintaining or proposed maintaining authority for any school likely to be affected by the proposals;
- the governing body of other schools which the proposer consider are likely to be affected by the proposals

- in the case of proposals affecting nursery provision any independent or voluntary providers who may be affected including Mudiad Meithrin;
- in the case of proposals affecting nursery provision, the Children and Young People's Partnership and/or the early years Development and Childcare Partnerships where present;

This will ensure that key stakeholders are able to respond to the proposal with any concerns they may have in relation to the impact of the proposal to change the age range of Ysgol Bro Banw from 4-11 to 3-11.

This will allow the Cabinet to consider all views and potential impacts before making a decision on how to proceed.

- ***The extent to which proposals will integrate early years education with childcare services or are consistent with an integrated approach.***

Should the proposal proceed there would be an opportunity for wrap around care provision to be accommodated by a number of local providers who are within a mile of the school.

Quality and standards in education

The School Organisation Code (2018) requires an analysis of the likely impact of the proposals on the quality and standards of education in the school, taking into account the relevant Estyn inspection areas, which are outlined in the following section.

Current school priorities / Estyn recommendations:

Ysgol Bro Banw was last inspected in January 2024 and is currently in "No Follow Up". This means that the school has met the required standards of the inspection and does not require any additional monitoring or intervention from Estyn.

As a result of the last visit, Estyn made the following recommendations:

- Improve attendance
- Improve standards in Welsh in English-medium classes

The likely impact of the proposals on Ysgol Bro Banw:

The Council's view is that Ysgol Bro Banw would provide education for pupils from 3 –11 which is of at least equivalent quality to the 4–11 provision that is currently provided, so should it proceed it is not anticipated that implementation of this option, if adopted, would have a negative impact on standards and progress overall.

Learning - standards and progress overall:

- It is noted in the inspection report that during their time at the school, most pupils, including those eligible for free school meals, those with additional learning needs (ALN) and those who have English as an additional language

(EAL), make strong progress in developing their skills, knowledge and understanding. Nearly all pupils in the specialist teaching provisions make good progress towards their individual targets.

- Most younger pupils listen attentively and follow simple instructions well. They interact effectively with adults and develop sound communication skills.
- Most nursery and reception pupils enjoy listening to stories and re-telling them to their friends and adults. They develop positive attitudes to reading and become familiar with the content of books.
- Many pupils' writing skills develop consistently well over time. The youngest pupils develop secure fine motor skills that prepare them for early writing. Across the Foundation Learning classes, many pupils write descriptive and interesting pieces with increasing accuracy and use language for effect.
- Younger pupils engage enthusiastically in practical activities that support the development of their mathematical vocabulary and number skills.
- Across the school, most pupils develop their physical skills well through a wide range of purposeful experiences. The youngest pupils are enthusiastic about physical activities in the outdoor area, including cycling and exercise sessions.
- Should the proposal proceed, it is unlikely to have a negative impact as learning and progress within the early years is strong.

Wellbeing and attitudes to learning:

- It is noted in the inspection report that nearly all pupils are proud of their school and develop a strong sense of belonging. They value the positive working relationships they develop with staff, who provide them with encouragement, direction and support. Most pupils thrive in the school's nurturing environment and feel safe there.
- Most pupils behave well around the school and are extremely courteous and welcoming to adults and visitors. They show care and consideration for each other and collaborate effectively, showing respect for the contributions of other pupils in class.
- Most have a firm sense of right and wrong and understand the importance of supporting children's rights. The inclusive, friendly and nurturing ethos of the school is reflected in pupils' attitudes towards each other, particularly when welcoming new pupils to the school.
- Across the school, most pupils have strong, positive attitudes to learning. They engage positively with the broad range of exciting and stimulating learning experiences that the school offers. Most settle quickly and develop confidence and resilience when persevering with their work or play.
- Should the proposal proceed it is unlikely to have a negative impact as the school has an effective nurturing environment, that impacts positively on learners' behaviour and wellbeing.

Teaching and learning experiences:

- Estyn identified that a notable strength of the school is the wealth of rich learning experiences on offer for pupils. Leaders and staff have worked effectively together to plan and deliver a bespoke, innovative and highly stimulating curriculum. Teachers are skilful in ensuring an effective balance of direct teaching and inquiry-based learning. As a result, the curriculum provides a comprehensive range of authentic learning experiences for all pupils
- Most teachers use the principles of foundation learning well to plan a good range of enjoyable, hands-on learning and play experiences for younger pupils. The consistent use of real-life authentic experiences helps to engage pupils in their learning and develop their skills and knowledge effectively.
- An excellent feature of the school's curriculum is the strong emphasis placed on developing pupils' awareness of their 'cynefin' or local area and of the history and heritage of Wales.
- All staff have highly effective working relationships with pupils and treat them with kindness and respect. This fosters a positive and supportive environment for learning within the school community. They provide excellent support for pupils with additional needs in the mainstream and specialist teaching provision classes. Nearly all teachers ensure that their lessons have an effective pace and encourage pupils to work together to complete tasks and solve problems.
- It is unlikely that the above proposal, should it proceed will have a negative impact, as the curriculum is innovative and highly stimulating, ensuring it meets the needs of all learners.

Care, support and guidance:

- It is noted in the inspection report that the school is a highly inclusive, caring and compassionate community where the well-being of everyone is a priority for leaders and staff. Pupils have equal access to nearly all aspects of school life and provide exemplary care, support and guidance for all pupils, particularly for those with ALN.
- Staff provide a wide range of effective strategies and interventions to help pupils improve their skills, well-being and attitudes to learning.
- Rigorous and robust systems are in place to help identify and monitor pupils in need of additional support in mainstream classes to ensure they make strong progress in relation to their starting points.
- A notable feature of the school's provision is the exceptional arrangements to support pupils' social, moral, and cultural development. Teachers ensure that pupils influence what and how they learn, as well as encouraging them to discuss a range of important current issues.
- The school has a strong, effective and well-established safeguarding culture.
- It is unlikely that the above proposal, should it proceed will have a negative impact, as the school is a highly inclusive and caring community that is highly effective in supporting the wellbeing of all learners. The school has robust policies in place to support learners within their environment.

Leadership and management

- It is noted in the inspection report that the headteacher provides highly effective, supportive and compassionate leadership, which has a positive impact on the lives of pupils and their families. He has developed a strong team ethos, which ensures that all staff collaborate successfully to ensure that the school's vision of 'Encouraging every child to shine' is at the heart of its work.
- Leaders use a useful range of self-evaluation tools to identify strengths and areas for improvement well. Purposeful monitoring processes ensure that leaders, staff and members of the governing body are all involved in evaluating the school's work.
- The school has identified a suitable range of improvement priorities, that focus very well on teaching and learning, pupils' well-being and leadership. The school's effective self-evaluation and improvement planning processes ensures that leaders have improved many important aspects of the school's work over the last few years.
- Should it proceed, this proposal will likely lead to an increase in pupil numbers that will have a positive effect on the efficient use of resources to contribute to a sustainable future for the school.

Vulnerable groups including learners with ALN and learners from economically deprived backgrounds:

- Should this proposal proceed, it is anticipated that learner outcomes will be enhanced as learners are integrated into an appropriate learning environment from an earlier age.

Impact of the proposals on vulnerable groups, including children with Special Educational Needs (SEN)

Providing part-time 3-year-old non-statutory early years education provision at Ysgol Bro Banw will benefit vulnerable groups, including children with Additional Learning Needs (ALN) as it enables the early observation and assessment of learners and supports early identification of needs and timely interventions.

The ability of the school to deliver the full curriculum at the foundation phase and each key stage of education

The Council has no concerns regarding the quality of teaching and learning and the school has the ability to deliver a purposeful curriculum to meet the needs of all learners.

Need for places and the impact on accessibility of schools

The School Organisation Code (2018) requires relevant bodies to take into account the following points in relation to the need for places and impact on accessibility of schools:

- ***The extent to which the proposal would support the targets in the approved Welsh in Education Strategic Plan (WESP)***

Carmarthenshire's Welsh in Education Strategic Plan (WESP) 2022 - 2032 aims to facilitate an increase in the number of people of all ages able to use the Welsh language with their families, in their communities and in the workplace.

This proposal would offer Welsh medium nursery education for three-year-olds at both Ysgol Gymraeg Rhydaman and Ysgol Bro Banw and would strengthen the transition between Welsh medium nursery provision and primary education in the Ammanford town area.

- ***How the proposal would expand or reduce Welsh language provision***

Should proposals proceed, it would ensure access to Welsh language Early Years provision for the Ammanford town area at both Ysgol Gymraeg Rhydaman and Ysgol Bro Banw. There will be no reduction in Welsh language provision.

Where a new school, increase in capacity or age range expansion is proposed;

Evidence of current or future need/demand in the area for additional places, with reference to the school or proposed school's language category, designated religious character, and the gender intake (i.e. co-educational/single sex);

The demand for additional provision of any type in an area **should** be assessed and evidenced. (In the case of Welsh medium provision this would include an assessment of the demand for Welsh Medium education conducted in accordance with any regulations made under section 86 of the 2013 Act).

- ***Whether proposals will improve access for disabled pupils in accordance with requirements under the Equality Act 2010***

The school has an accessibility plan. However, should a pupil require any adaptations to the school, reasonable adjustments will be made for the pupil in line with established Carmarthenshire County Council School Organisation processes.

Resourcing of education and other financial implications

The School Organisation Code (2018) requires relevant bodies to take into account the following points in relation resourcing of education and other financial implications:

- ***What effect proposals will have on surplus places in the area***

It is anticipated, if proposals proceed that the change in age range of Ysgol Bro Banw from 4-11 to 3-11 would positively impact on the removal of any surplus places at the school.

- ***The recurrent costs of proposals over a period of at least 3 years and whether the necessary recurrent funding is available***

Local Authority maintained 3-11 schools receive delegated formula funding for the provision of 3-year-old education on a part-time basis. This equates to 50% of the per capita funding for primary pupils. In 2025-26 this figure is £2044 per pupil on roll at the time of the Pupil Level Annual School Census (PLASC) which takes place in the January preceding the following financial year. This is additional funding for a school currently designated as 4-11 and which becomes 3-11.

- ***Staffing***

It is anticipated that the nursery (dependent on final numbers) would be staffed in line with current arrangements in Early Years provision.

- ***The sources from which capital funding will be provided***

Should the proposal proceed it is not expected to require any capital funding.

- ***How any capital receipts or recurrent costs savings will be deployed***

There is no transfer or disposal of land or buildings associated with this proposal.

- ***Additional Transport Costs/Learner Travel Arrangements***

To qualify for free transport pupils must meet a number of criteria as outlined in [Carmarthenshire County Council - School Transport Policy](#), one of which is that pupils are of compulsory school age. As the provision of early years education is for pupils under compulsory school age, free transport would not be available for pupils therefore the proposal does not have any associated transport costs.

Other general Factors

The School Organisation Code (2018) requires relevant bodies to take into account the following points in relation to other general factors:

- ***Impact of the proposal on educational attainment among children from economically deprived backgrounds***

Providing part-time 3-year-old non-statutory early years education provision at Ysgol Bro Banw will benefit vulnerable groups, including learners with Additional Learning Needs (ALN) and learners from economically deprived backgrounds as it enables the early observation and assessment of learners and supports early identification of needs and timely interventions.

We are wholly confident that learner outcomes will be enhanced as learners are integrated into an appropriate learning environment from an earlier age.

- ***Equality issues, including those identified through equality impact assessments***

There are no apparent equality issues identified through the Integrated Impact Assessment at this stage. The initial Integrated Impact Assessment does not highlight any disproportionate impact on any of the protected characteristics. Should the proposal proceed, this Assessment will be reviewed and updated at key points as necessary.

Admissions Arrangements

The County Council is the Admissions Authority for Ysgol Bro Banw:

The School Admissions Unit,
Carmarthenshire County Council ,
Department for Education and Children,
Building 3,
Spilman Street,
Carmarthen,
SA31 1LE
Tel No: 01267 246449

E-mail: admissions@carmarthenshire.gov.uk

Admission to Early Years

Early years education is a non-statutory provision available to 3-year-olds and an application for admission to provision within a school will have to be made to the correct Admissions authority by the closing date.

All 3-year-olds are entitled to a minimum of 10 hours per week funded placement, at a registered setting, through the Early Entitlement Group from the term following their third birthday.

Children will normally be admitted to early years provision in schools where it is available on a part-time basis at the beginning of the term following their third birthday.

Child's 3rd Birthday	Admission Term
1 September – 31 December	Spring Term
1 January – 31 March	Summer Term
1 April – 31 August	Autumn Term

Parents / guardians do not have a right of appeal if a place is not offered at an early years setting of their choice.

There is no automatic right to continue into full time education if you have been offered a part-time education place. A formal application must be made to the correct admissions authority.

Further information on the School Admissions policy and process can be found on the Council website.

, Should this proposal proceed, in line with Welsh Government statutory requirements, the Council's Admissions Team would undertake a one off admissions exercise outside of normal arrangements, to ensure parents within the Ammanford community have an opportunity to apply for the nursery age places commencing September 2026.

Integrated Impact Assessment

An integrated impact assessment (IIA) has been undertaken to help us to ensure we have considered how different groups and services could be affected by our proposals, enabling us to strengthen positive aspects and mitigate any potentially negative impacts.

The integrated impact assessment incorporates the requirements of the following Acts into one Impact Assessment:

- Well-being of Future Generations (Wales) Act 2015
- Public Sector Equality Duty and the Equality Act 2010
- Socio-Economic Duty 2021
- Welsh Language Measure 2011 and Welsh Language Standards
- United Nations Convention on the Rights of the Child (UNCRC) & Rights of Children and Young Persons (Wales) Measure 2011
- Environment (Wales) Act 2016 – biodiversity and ecosystem resilience

General Data Protection Regulation.

3. The Proposal Ysgol Gymraeg Rhydaman

The Proposal

The proposal is to change the age range of Ysgol Gymraeg Rhydaman from a 4-11 school to a 3-11 school from September, 2026.

Current Arrangements – Status Quo

Ysgol Gymraeg Rhydaman is located in the town of Ammanford within a mixed commercial and residential area. The school occupies a site adjoining Ysgol Bro Banw

(Junior unit) and Ammanford Nursery. The catchment area for Ysgol Gymraeg Rhydaman is the same as Ysgol Bro Banw.

Ysgol Gymraeg Rhydaman is currently a 4-11 Welsh medium (category 3) age school and does not offer part time non statutory 3-year-old early years education provision. This leads to a gap in the provision of education within the school between the age of 3 and 4. early years education provision is currently provided at Ammanford Nursery school which is located next door to the school. Historically in the main parents have chosen to send their children from Ammanford Nursery to both Ysgol Bro Banw and Ysgol Gymraeg Rhydaman and other schools.

Current arrangements/status quo do not provide Ysgol Gymraeg Rhydaman with equitable early years education provision with other 3-11 schools in the county. By discontinuing Ammanford Nursery and increasing the age range of Ysgol Gymraeg Rhydaman this would provide equity with other 3-11 primary schools in Carmarthenshire and partially fill the gap in education provision created by the nursery closure.

Early years education is a non-statutory provision available to 3-year-olds. All 3-year-olds are entitled to a minimum of 10 hours per week funded placement, at a registered setting, through the Early Entitlement Group from the term following their third birthday.

There are various types of early years provision available across Carmarthenshire:

- 1 Nursery school (Ammanford)
- Nursery/Early Years Classes in 3-11 primary schools
- Provision by the non-maintained sector who are partners in the Early Entitlement Group, such as early years Wales, Mudiad Meithrin (MM) and private providers.

Strengths of the Status Quo

- No change for staff, pupils and the wider community
- No statutory procedures needed
- No impact to Ammanford Nursery

Weaknesses of the Status Quo

- The school does not offer equity of nursery provision in line with other 3-11 Welsh medium schools in Carmarthenshire
- The school does not offer early years education provision on site
- Does not provide potential continuity of Education when compared with a 3-11 primary school
- Missed opportunity to immerse pupils in the Welsh Language at a younger age improving linguistic development
- Does not offer equality with other 3-11 Welsh medium schools in Carmarthenshire

Benefits to accessing early years education on a school site

- Early development of foundational skills
- Early identification of learning needs

- Early parental engagement
- Aids transition to primary and lifelong learning

Benefits and Disadvantages of the proposal:

Benefits	Disadvantages
Benefits linguistic development of the Welsh Language at an earlier age in response to the Welsh in Education Strategic Plan with the Local Authority, and the Welsh Government's ambition of reaching one million Welsh speakers by 2050	Discontinuation of Ammanford Nursery
Gradual and supported transition for 3-year-olds entering school, starting with half days and progressing to full school days.	Reduction in the demand for places at the privately-run nurseries and childminders who currently provide all day provision.
Improve education standards for children in the area and significantly strengthen the transition from nursery to primary age pupils in the Welsh-medium sector, offering continuity and uninterrupted progression to pupils	
Provides effective and sustainable provision to ensure progress in line with the requirements of Curriculum for Wales and in response to national standards and local policies	
Increased opportunity to immerse pupils in the Welsh Language at a younger age, improving linguistic development	
Nursery provision available on the school site	
May attract more pupils to attend the school	
Potential opportunity for employment at Gymraeg Rhydaman	
Will attract additional pupil-led funding to the school	

Risk Management:

Risk		Risk Management
1.	Failure to obtain statutory approval to implement the proposal	Follow guidelines set out in the School Organisation Code 2018
2.	Effect on local economy through loss of numbers at private nursery providers	Consult with private providers openly in regard to the proposal.
3.	The nursery class at the school does not receive sufficient applications	Number of applications cannot be predicted. This will be monitored by the admissions team.

Alternative Options considered:

Alternative Option	Description	Reason for discounting
Option 1	Status Quo no change to Ysgol Gymraeg Rhydaman	Does not align with County Council aspirations for 3-11 provision across Carmarthenshire.
Option 2	Provide early years Provision at Neighbouring Schools	Pupils have to travel out of catchment to access non-statutory 3-year-old early years education provision at other schools. Pupils may not be admitted if there are capacity pressures at the schools.

Specific factors where proposals concern adding nursery classes

- ***The standard of nursery education and the sufficiency of accommodation and facilities offered, both in the classroom and outdoors, and the viability of any school that wishes to add nursery places.***

Should this proposal proceed it is expected that extending the age range at Ysgol Gymraeg Rhydaman from 4–11 to 3–11, along with expanding its provision to include early years education, will fill the gap in provision created by the closure of Ammanford Nursery. This change will align the school with other 3-11 schools in Carmarthenshire. The introduction of early years education has the potential to increase pupils choosing to attend the school, further supporting the school's long-term sustainability.

It is proposed that Ammanford nursery be discontinued and its former site utilised to provide sufficient classroom space to accommodate nursery provision and outdoor areas at Ysgol Gymraeg Rhydaman.

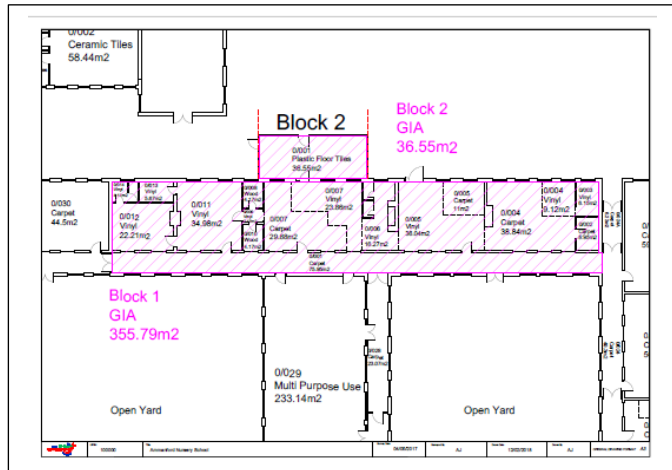

- ***Whether there is a need for additional nursery places in the area.***

Currently nursery places are provided at Ammanford Nursery school. Should this proposal proceed it will replace the provision currently provided at Ammanford Nursery to ensure equitable access to early years education in line with other 3-11 primary schools in the county at Ysgol Gymraeg Rhydaman and Ysgol Bro Banw.

- ***The levels of demand for certain types of nursery education e.g. Welsh medium or provision with a religious character.***

Currently nursery places are provided at Ammanford Nursery school in both a Welsh and English stream. If proposals proceed it will ensure equitable access to early years education with other 3-11 primary schools in the county.

- ***The effect of the proposals on other institutions, including private and third sector providers.***

In accordance with the School Organisation Code (2018), the Consultation Document will be shared with key stakeholders who may be impacted by the proposal, including, but not limited to:

- the maintaining or proposed maintaining authority for any school likely to be affected by the proposals;
- the governing body of other schools which the proposer consider are likely to be affected by the proposals
- in the case of proposals affecting nursery provision any independent or voluntary providers who may be affected including Mudiad Meithrin;
- in the case of proposals affecting nursery provision, the Children and Young People's Partnership and/or the early years Development and Childcare Partnerships where present;

This will ensure that key stakeholders are able to respond to the proposal with any concerns they may have in relation to the impact of the proposal to change the age range of Ysgol Gymraeg Rhydaman from 4-11 to 3-11.

This will allow the Cabinet to consider all views and potential impacts before making a decision on how to proceed.

- ***The extent to which proposals will integrate early years education with childcare services or are consistent with an integrated approach.***

Should the proposal proceed wrap around care provision could be accommodated by a number of local providers who are within a mile of the school.

Quality and standards in education

The School Organisation Code (2018) requires an analysis of the likely impact of the proposals on the quality and standards of education in the school, taking into account the relevant Estyn inspection areas, which are outlined in the following section.

Current school priorities / Estyn recommendations:

Ysgol Gymraeg Rhydaman was last inspected by Estyn in October 2024 and currently is in No Follow Up.

As a result of its last visit, Estyn made the following recommendations:

- Continue to implement arrangements to alleviate the lack of space in some classes over a short period, with a view to implementing a longer-term plan to expand the learning area.

The likely impact of the proposals on Ysgol Gymraeg Rhydaman:

The Councils view is that Ysgol Gymraeg Rhydaman would provide education for pupils from 3 – 11 which is of at least equivalent quality to the 4 – 11 provision that is currently provided, so should it proceed, it is not anticipated that implementation of this option, if adopted, would have any negative impact on standards and progress overall.

Learning - standards and progress overall:

- It is noted in the inspection report that the Welsh speaking and communication skills of nearly all of the youngest pupils develop soundly, for example when role-playing in the school cafe. As they move through the school, the literacy skills of nearly all pupils develop well in both languages.
- Nearly all pupils make sound progress in their reading and writing skills, for example as the youngest pupils read books about important Welsh buildings and use this information to write interesting facts for others.

- Nearly all pupils' mathematics and digital skills develop soundly from an early age. Nearly all pupils apply their numeracy skills confidently and with increasing independence.
- Should the proposal proceed, it is unlikely to have a negative impact as learning and progress within the early years is strong.

Wellbeing and attitudes to learning:

- It is noted in the inspection report that all members of staff have a close and warm relationship with pupils. They use a range of effective behaviour management techniques and, as a result, nearly all pupils behave well and demonstrate very positive attitudes to learning.
- Should the proposal proceed, it is unlikely to have a negative impact as the school has an effective inclusive ethos, that impacts positively on learners' behaviour and wellbeing.

Teaching and learning experiences:

- It is noted in the inspection report that teachers work together purposefully to provide a broad and balanced curriculum that is rooted in the local area. By planning a variety of stimulating and engaging educational activities, they provide valuable opportunities for pupils to learn about the culture, history and heritage of the local area and Wales.
- The purposeful use of the rich learning areas is a clear strength of provision. Staff provide engaging and stimulating learning activities in the learning areas which develop a range of pupils' skills very effectively.
- Teachers use a range of effective teaching methods successfully. They question pupils skilfully, which extends their knowledge and understanding of different contexts further.
- It is unlikely that the above proposal, should it proceed will have a negative impact, as the curriculum is broad and engaging, ensuring they meet the needs of all learners.

Care, support and guidance:

- It is noted in the inspection report that staff promote important principles, such as kindness, respect and being friendly effectively. Within collective worship sessions, for example, pupils are given valuable opportunities to discuss the importance of being informed and caring citizens.
- The school has robust processes for identifying pupils with additional needs at an early stage. Staff provide purposeful support programmes that are effective in responding to pupils' needs and track their progress regularly. Staff work closely with parents to seek their views and share timely information about their children's development.
- It is unlikely that the above proposal, if it proceeds, will have a negative impact, as there is an inclusive and caring community that is effective in supporting the wellbeing of all learners. The school has robust policies in place to support learners within their environment.

Leadership and management:

- It is noted in the inspection report that under the headteacher's robust leadership, a dedicated team of staff acts to ensure that pupils learn and develop their skills to the best of their ability. The headteacher models and embraces the values of Welshness, happiness, respect and friendship which form the basis of her vision of creating 'A valley full of learning and healthy laughter, and fire for the language in every small child'.
- One of the school's obvious strengths is the strong sense of team that exists between staff and governors. They work together extremely effectively to improve the provision offered to pupils. In turn, this has a positive effect on the development of nearly all pupils' skills, knowledge and understanding.
- The school uses a clear range of self-evaluation activities each term, including learning walks, scrutinising work and questioning pupils, which have a very positive effect on the ability of staff and governors to identify the school's strengths and all areas for improvement.
- The productive relationship between the school, the community and parents is an obvious strength.
- If it proceeds, this proposal will likely lead to an increase in pupil numbers that will have a positive effect on the efficient use of resources to contribute to a sustainable future.

Vulnerable groups including learners with ALN and learners from economically deprived backgrounds:

- Providing part-time 3-year-old non-statutory early years education provision at Ysgol Gymraeg Rhydaman will benefit vulnerable groups, including learners with Additional Learning Needs (ALN) and learners from economically deprived backgrounds as it enables the early observation and assessment of learners and supports early identification of needs and timely interventions.
- Should this proposal proceed, it is anticipated that learner outcomes will be enhanced as learners are integrated into an appropriate learning environment from an earlier age.

Impact of the proposals on vulnerable groups, including children with Special Educational Needs (SEN)

Providing part-time 3-year-old non-statutory early years education provision at Ysgol Gymraeg Rhydaman will benefit vulnerable groups, including children with Additional Learning Needs (ALN) as it enables the early observation and assessment of learners and supports early identification of needs and timely interventions.

The ability of the school to deliver the full curriculum at the foundation phase and each key stage of education

The Council has no concerns regarding the quality of teaching and learning and the school has the ability to deliver a purposeful curriculum to meet the needs of all

learners and therefore it is not expected that there will be any discernible impact if proposals proceed.

Need for places and the impact on accessibility of schools

The School Organisation Code (2018) requires relevant bodies to take into account the following points in relation to the need for places and impact on accessibility of schools:

- ***The extent to which the proposal would support the targets in the approved Welsh in Education Strategic Plan (WESP)***

Carmarthenshire's Welsh in Education Strategic Plan (WESP) 2022 - 2032 aims to facilitate an increase in the number of people of all ages able to use the Welsh language with their families, in their communities and in the workplace.

This proposal supports Outcome 1 'More nursery age / three-year olds receive their education through the medium of Welsh'. Changing the age-range of Ysgol Gymraeg Rhydaman from 4-11 to 3-11 will provide part-time 3-year-old education provision at Ysgol Gymraeg Rhydaman strengthening the transition between Welsh medium nursery provision and primary education.

- ***How the proposal would expand or reduce Welsh language provision***

If the proposal to change the age range of Ysgol Gymraeg Rhydaman from 4-11 to 3-11 were to proceed, it would expand Welsh language provision as it would establish Welsh medium early years education in the Ysgol Gymraeg Rhydaman catchment area enabling pupils to access Welsh medium education from an earlier age.

Where a new school, increase in capacity or age range expansion is proposed;

Evidence of current or future need/demand in the area for additional places, with reference to the school or proposed school's language category, designated religious character, and the gender intake (i.e. co-educational/single sex);

The demand for additional provision of any type in an area **should** be assessed and evidenced. (In the case of Welsh medium provision this would include an assessment of the demand for Welsh Medium education conducted in accordance with any regulations made under section 86 of the 2013 Act).

- ***Whether proposals will improve access for disabled pupils in accordance with requirements under the Equality Act 2010***

The school has an accessibility plan. However, should a pupil require any adaptations to the school, reasonable adjustments will be made for the pupil in line with established Carmarthenshire County Council School Organisation processes.

Resourcing of education and other financial implications

The School Organisation Code (2018) requires relevant bodies to take into account the following points in relation resourcing of education and other financial implications:

- ***What effect proposals will have on surplus places in the area***

There are currently no surplus places at Ysgol Gymraeg Rhydaman.

- ***The recurrent costs of proposals over a period of at least 3 years and whether the necessary recurrent funding is available***

Local Authority maintained 3-11 schools receive delegated formula funding for the provision of 3-year-old education on a part-time basis. This equates to 50% of the per capita funding for primary pupils. In 2025-26 this figure is £2044 per pupil on roll at the time of the Pupil Level Annual School Census (PLASC) which takes place in the January preceding the following financial year. This is additional funding for a school currently designated as 4-11 and which becomes 3-11.

- ***Staffing***

The school will manage the staffing of the Early Years education provision in line with current arrangements.

- ***The sources from which capital funding will be provided***

If proposals proceed it is not expected to require any capital funding.

- ***How any capital receipts or recurrent costs savings will be deployed***

Procedures will be put in place to transfer assets to Ysgol Gymraeg Rhydaman.

- ***Additional Transport Costs/Learner Travel Arrangements***

To qualify for free transport pupils must meet a number of criteria as outlined in [Carmarthenshire County Council - School Transport Policy](#), one of which is that pupils are of compulsory school age. As the provision of early years Education is for pupils under compulsory school age, free transport would not be available for pupils therefore the proposal does not have any associated transport costs.

Other general Factors

The School Organisation Code (2018) requires relevant bodies to take into account the following points in relation to other general factors:

- ***Impact of the proposal on educational attainment among children from economically deprived backgrounds***

Providing part-time 3-year-old non-statutory early years education provision at Ysgol Gymraeg Rhydaman will benefit vulnerable groups, including learners with Additional Learning Needs (ALN) and learners from economically deprived backgrounds as it enables the early observation and assessment of learners and supports early identification of needs and timely interventions.

We are wholly confident that learner outcomes will be enhanced as learners are integrated into an appropriate learning environment from an earlier age.

- ***Equality issues, including those identified through equality impact assessments***

There are no apparent equality issues identified through the Integrated Impact Assessment at this stage. The initial Integrated Impact Assessment does not highlight any disproportionate impact on any of the protected characteristics. Should the proposal proceed, this Assessment will be reviewed and updated at key points as necessary.

Admissions Arrangements

The County Council is the Admissions Authority for Ysgol Gymraeg Rhydaman:

The School Admissions Unit,
Carmarthenshire County Council ,
Department for Education and Children,
Building 3,
Spilman Street,
Carmarthen,
SA31 1LE
Tel No: 01267 246449

E-mail: admissions@carmarthenshire.gov.uk

Admission to Early Years

Early years education is a non-statutory provision available to 3-year-olds and an application for admission to provision within a school will have to be made to the correct Admissions authority by the closing date.

All 3-year-olds are entitled to a minimum of 10 hours per week funded placement, at a registered setting, through the Early Entitlement Group from the term following their third birthday.

Children will normally be admitted to early years provision in schools where it is available on a part-time basis at the beginning of the term following their third birthday.

Child's 3rd Birthday	Admission Term
1 September – 31 December	Spring Term
1 January – 31 March	Summer Term
1 April – 31 August	Autumn Term

Parents / guardians do not have a right of appeal if a place is not offered at an early years setting of their choice.

There is no automatic right to continue into full time education if you have been offered a part-time education place. A formal application must be made to the correct admissions authority.

Further information on the School Admissions policy and process can be found on the Council website.

Should this proposal proceed, in line with Welsh Government statutory requirements, the Council's Admissions Team would undertake a one off admissions exercise outside of normal arrangements, to ensure parents within the Ammanford community have an opportunity to apply for the nursery age places commencing September 2026.

Integrated Impact Assessment

An integrated impact assessment (IIA) has been undertaken to help us to ensure we have considered how different groups and services could be affected by our proposals, enabling us to strengthen positive aspects and mitigate any potentially negative impacts.

The integrated impact assessment incorporates the requirements of the following Acts into one Impact Assessment:

- Well-being of Future Generations (Wales) Act 2015
- Public Sector Equality Duty and the Equality Act 2010
- Socio-Economic Duty 2021
- Welsh Language Measure 2011 and Welsh Language Standards
- United Nations Convention on the Rights of the Child (UNCRC) & Rights of Children and Young Persons (Wales) Measure 2011
- Environment (Wales) Act 2016 – biodiversity and ecosystem resilience

General Data Protection Regulation.

School(s) likely to be affected by this proposal

School Name		Ysgol Betws	Ysgol Parcyrhun	Ysgol Y Bedol	Ysgol Llandybie	Ysgol Blaenau	Ysgol Ffairfach
School Location		Betws, Ammanford SA18 2HE	Villiers Road, Ammanford SA18 3HB	Folland Road, Garnant, SA18 2GB	Parc y Llan, Llandybie, Ammanford, SA18 3JB	Blaenau, Ammanford, SA18 3BQ	Ffairfach, Llandeilo, SA19 6SY
Age Range		3-11	4-11	3-11	3-11	4-11	4-11
School Category (Community [C], Voluntary Aided [VA], Voluntary Controlled [VC])		Community Primary	Community Primary	Community Primary	Community Primary	Community Primary	Community Primary
Language Category		3,2	2	3	T3	3	3
Number of registered Pupils (PLASC 2025)	Nursery	10	14	35	29	1	4
	Reception – Y.6	73	182	248	172	38	65
	Total	83	196	283	201	39	69
Number of pupils previously on the register (PLASC inc nursery pupils)	January 2024	82	200	290	193	38	76
	January 2023	70	212	309	209	43	91
	February 2022	73	206	306	222	41	95
	April 2021	70	220	340	239	34	101

School Name		Ysgol Betws	Ysgol Parcyrhun	Ysgol Y Bedol	Ysgol Llandybie	Ysgol Blaenau	Ysgol Ffairfach
Pupil Projections (excluding nursery) (2025)	January 2026	75	183	243	169	37	62
	January 2027	77	185	230	164	39	66
	January 2028	81	187	223	161	36	65
	January 2029	83	182	224	161	37	68
	January 2030	84	187	225	161	36	70
Nursery Capacity 24/25		14	27	24	38	12	12
Reception -Y6 Capacity 24/25		104	194	372	200	87	90
Total Capacity 24/25		118	221	396	238	99	102
Nursery Capacity 25/26		10	24	46	41	11	13
Reception -Y6 Capacity 25/26		76	195	325	209	87	97
Total Capacity 25/26		86	219	371	250	98	110
Cost per pupil (2024/25)		£4,620	£5,568	£5,772	£4,892	£5,828	£4,979
School Budget (2024/25)		£360k	£1,158k	£1,723k	£890k	£221k	£378k

School Name	Ysgol Betws	Ysgol Parcyrhun	Ysgol Y Bedol	Ysgol Llandybie	Ysgol Blaenau	Ysgol Ffairfach
Estyn Inspection Result	Inspection Report Ysgol Betws 2020 www.estyn.gov.wales	Inspection Report Ysgol Gynradd Parcyrhun 2025 www.estyn.gov.wales	Inspection Report Ysgol Y Bedol 2018 www.estyn.gov.wales	Inspection Report Llandybie CP 2022 www.estyn.gov.wales	Inspection Report Ysgol Gynradd Blaenau 2024 www.estyn.gov.wales	Inspection Report Ysgol Gynradd Ffairfach 2023 www.estyn.gov.wales
Building Condition Category (2024)	B	B	A	C	B	B

Appendix A – Response Form

Carmarthenshire County Council is consulting on the proposal to reconfigure nursery provision in Ammanford by:

1. Discontinuing Ammanford Nursery School

Whilst also,

2. extending the age range at Ysgol Bro Banw from 4-11 to 3-11
3. extending the age range at Ysgol Gymraeg Rhydaman from 4-11 to 3-11

to accommodate pupils from Ammanford nursery school

The following response form allows you to comment on the main proposal, the alternative options and to suggest other alternative options.

Consultees can submit views either in favour of or against a proposal.

Responses received during the consultation period will not be treated as objections and that if they wish to object, that they need to do so in writing during the statutory objection period.

-
1. Please specify which school you are associated with:

☐

Ammanford Nursery

☐

Ysgol Bro Banw

☐

Ysgol Gymraeg Rhydaman

☐

Another school

☐

No association

2. Please let us know do you support:

Proposal 1 – Discontinuing Ammanford Nursery School

Yes		No		In part		No opinion	
-----	--	----	--	---------	--	------------	--

Any additional comments?

--

Proposal 2 – Extending the age range at Ysgol Bro Banw from 4-11 to 3-11

Yes		No		In part		No opinion	
-----	--	----	--	---------	--	------------	--

Any additional comments?

--

Proposal 3 – Extending the age range at Ysgol Gymraeg Rhydaman from 4-11 to 3-11

Yes		No		In part		No opinion	
-----	--	----	--	---------	--	------------	--

Any additional comments?

--

3. Are you responding as a:

☐ Parent/ carer or guardian

☐ Prospective parent/ carer or guardian

☐ Governor

☐ Staff

☐ Member of the community

☐ Community Council

☐ Other: Please specify

4. Do you have any comments regarding this proposal that you would like us to consider?

5. Are there any other options that you think the Local Authority should be considering for the Ammanford town area?

☐ Yes

☐ No

If yes, please outline the alternative option(s):

6. We are required by the Welsh Language Standards to consider the effects of any policy decisions on the Welsh Language.

a. In your opinion, what positive or adverse effects would this proposal have on opportunities for persons to use the Welsh language and to treat the Welsh language no less favourably than the English language?

b. How do you think the proposal could be formulated or revised so that it would have positive or more positive effects on opportunities for persons to use the Welsh language and to treat the Welsh language no less favourably than the English language?

c. How do you think the proposal could be formulated or revised so that it would not have adverse effects or have less adverse effects on opportunities for persons to use the Welsh language and to treat the Welsh language no less favourably than the English language?

7. At the end of the consultation period, a Consultation Report will be published summarising the issues raised by consultees and the Local Authority's response to those issues.

Would you like to be informed of the publication of the Consultation Report:

☐ Yes

☐ No

If yes, please provide an e-mail address or postal address and language preference (English/Welsh):

Thank you for completing the response form.

Completed response forms should be sent to:

Mr Owain Lloyd,
Director of Education and Children's Services,
County Hall,
Carmarthen
Carmarthenshire
SA31 1JP

or by sending a scanned copy via e-mail to
MEPConsultations@carmarthenshire.gov.uk

Alternatively, you can complete this form online [SNAP SURVEY](#)

Please return your response by 16/10/25. Responses received after this date will not be considered.

Appendix B - Welsh Language Impact Assessment – Ammanford Nursery

Proposal & Background

Carmarthenshire County Council is proposing to discontinue Ammanford Nursery from September, 2026 and this Welsh Language Impact Assessment underpins the Council's proposal.

The [Well-being of Future Generations \(Wales\) Act 2015](#) requires public bodies across Wales named in the act to work towards seven well-being goals, including 'A Wales of Vibrant Culture and Thriving Welsh Language'.

Cymraeg 2050 is the Welsh Government's strategy for the promotion and facilitation of the use of the Welsh language and its vision is that the Welsh language belongs to everyone in Wales. The Welsh Government's ambition for increasing the use of Welsh and the number of people who speak the language is also noted, as is the commitment to work towards securing a million Welsh speakers by 2050 and to continue to encourage more people to use and speak Welsh in their everyday lives.

Cymraeg 2050 is the main policy driving the changes to the statutory process around planning Welsh-medium education. The Cymraeg 2050 strategy notes that Welsh-medium immersion education is the principal method for ensuring that children can develop their Welsh language skills, and for creating new speakers. It also highlights the importance of the early years sector as a point of early entry to immersion education, and as a way to increase demand for Welsh-medium education.

Welsh in Education Strategic Plan (2022-2032) & Welsh Language Promotion Strategy (2023-28)

Carmarthenshire County Council's [Welsh in Education Strategic Plan \(WESP\) 2022 - 2032](#) (WESP), and [Welsh Language Promotion Strategy](#) directly support the Welsh Government's vision and are the cornerstones of the Council's contribution towards meeting the target outlined in the Welsh Government's strategy. This proposal will ensure that Carmarthenshire County Council can carry out its statutory duties in relation to Welsh-medium education through its Welsh in Education Strategic Plan (WESP) and to facilitate an increase in the number of people of all ages able to use the Welsh language with their families, in their communities and in the workplace.

Carmarthenshire County Council's Welsh in Education Strategic Plan 2022-32 is clear in its aim and principle of developing our pupils' ability to use both Welsh and English fluently and confidently in a variety of situations. This will enable them to become full members of the bilingual society of which they are a part, fostering pride in the languages, heritage and culture of Carmarthenshire and Wales.

This proposal will contribute to realising the strategic objectives in the Carmarthenshire [Welsh Language Promotion Strategy \(2023-28\)](#) which aims '*To make Welsh the main language of the County and to restore Welsh to a language spoken and used by the majority of inhabitants consistently, and in all aspects of life*'.

The Future Direction of Education Services in Carmarthenshire 2022-2032

[Education Sir Gâr – The Future Direction of Education Service in Carmarthenshire 2022-2032](#) has clear priorities focussed around four key themes, tied into Our National Mission, the four purposes of Curriculum for Wales. Purpose 8 states that Carmarthenshire County Council "*will champion the Welsh Language and pride in Carmarthenshire's unique heritage and culture*".

Curriculum for Wales

The Welsh language is an integral part of [Curriculum for Wales](#) with the aim of ensuring an increase in the number of confident Welsh speakers within the statutory education system, and to ensure that in future, all learners can use Welsh after they have left school. It emphasises the fact that Welsh will remain compulsory up until the age of 16.

Who will this proposal effect directly?

The proposal will have an impact on pupils aged 3 - 5 and their families in the Ammanford area.

This proposal will have a positive impact on children and young people by offering additional choice in terms of Welsh-medium early years education from 3 years old at Ysgol Gymraeg Rhydaman. This in turn, from an early age, will offer children and young people Welsh language skills that they can use in all walks of life and in particular when they leave school and start work.

This proposal will allow Carmarthenshire County Council to increase the provision offered at Ysgol Bro Banw and Ysgol Gymraeg Rhydaman, which will have a positive impact on children and young people in the Ammanford area, regardless of their background,

or language of their family, ensuring that more and more children and young people develop Welsh language skills that can be used in everyday life.

We expect any impact to be positive, due to the following:

- Children and young people can take advantage of Welsh-medium education from 3 years of age
- The aims of this proposal will help Carmarthenshire County Council fulfil its commitments to the Welsh language, Welsh speakers and Welsh speaking communities.

Impact Criteria	Description	Status of the impact	Have any measures been identified to mitigate any negative impact or to create more positive opportunities?	Final impact (following mitigation methods)
The school's Language Category (formal)	<p>The school's language is defined as Category 2 – Dual Language</p> <p>Welsh and English will be used for internal communication as well as with parents and carers. There is clear understanding that maintaining a Welsh language ethos within the school will support positive attitudes towards Welsh language use. A learner in a school of this category will be able to speak, read, write and listen in English and Welsh according to age and ability and stream of education. Welsh language skills will be further strengthened by increasing the amount of learning opportunities (curricular as well as extra-curricular) offered through the medium of Welsh.</p>	Neutral	N/A	N/A

	<p>Where Welsh is used as a medium of 43 learning, occasional English is used at times to reinforce the learners' understanding. With the right support, learners could progress to a Category 3 Welsh-medium secondary school. At least 50% of the learners' school activities (both curricular and extra-curricular) will be in Welsh. This could be achieved in different ways depending on the school's context. It could be by using full Welsh-medium immersion up to age 7 with choice offered in the other year groups, or that 50% of school activities are in Welsh throughout.</p>			
<p>The school's Language Category (informal)</p>	<p>This proposal could strengthen the opportunities for pupils to use the Welsh language formally and informally with their peers from a younger age at the alternative school(s).</p> <p>With the change to 3-11 provision at Ysgol Bro Banw and Ysgol Gymraeg Rhydaman, we aim to work with all our partners to promote the benefits of bilingualism to ensure that all parents/carers and families can make an informed decision at the earliest possible time in their child's life.</p>	<p>Positive</p>	<p>N/A</p>	<p>N/A</p>

<p>Information about Welsh language standards at the school</p>	<p><u>Local Authority Input:</u></p> <p>At Ammanford Nursery School, most children make strong progress from their starting points. Practitioners model language particularly well, and this has a positive effect on children's oral skills in both streams.</p> <p>One of the school's strengths is the way in which most children develop their English oral skills well in the English stream, and their Welsh oral skills in both streams. Most listen attentively to adults and their peers. When discussing, they use an increasing range of vocabulary.</p> <p>Most children's early reading skills are developing soundly. They handle books with respect and understand that they read print from left to right. Many have a strong phonological knowledge and are beginning to use this knowledge to build words successfully. Many children discuss the content of class stories effectively, and older children predict what might happen next in the story sensibly. The writing skills of a majority of children are developing effectively. The school's provision effectively supports pupils' early writing development through a strong focus on pre-writing activities, including gross and</p>	<p>Positive</p>	<p>N/A</p>	<p>N/A</p>
---	--	-----------------	------------	------------

	<p>fine motor skill development, which build the necessary physical control for mark-making and writing. As they progress, pupils use an increasing range of equipment, including chalk, paint brushes, crayons and pencils successfully to make marks for different purposes. Many hold a pencil correctly when writing. Older children are beginning to form letters correctly, for example when writing their names fairly independently. In general, only a few children choose to write freely in the learning areas.</p> <p>Staff model language purposefully and ensure regular opportunities to extend children's vocabulary during activities, for example when role-playing in the cafe. They make good use of songs to develop children's language patterns and numeracy skills. In the English stream, staff promote the use of the Welsh language during everyday activities. These activities have a very positive effect on children's oral skills.</p> <p>Planning to develop the Welsh language is a strength in both streams. Practitioners ensure very beneficial opportunities for children to learn and sing Welsh songs and nursery rhymes regularly. Practitioners plan valuable opportunities to</p>		
--	--	--	--

	<p>develop children's awareness of Welsh history and culture.</p> <p>Impact of Proposed Change</p> <p>The proposed closure of Ysgol Feithrin Rhydaman would not negatively impact Welsh language provision in the area. Pupils would continue to have full access to high-quality Welsh-medium early years education at Ysgol Gymraeg Rhydaman and Ysgol Bro Banw.</p> <p>Both schools are well-established providers of Welsh-medium education and are equipped to support pupils in developing their Welsh language skills from the earliest stages. Importantly, learners would benefit from receiving their education within the same establishment from nursery through to the end of the primary phase. This continuity supports the progressive development of skills across the curriculum and promotes greater fluency and confidence in the Welsh language.</p> <p>The transfer of nursery provision to these settings would ensure that the Welsh language continues to thrive in the community, while also offering pupils a</p>		
--	---	--	--

	<p>consistent and supportive educational environment.</p> <p><u>Ammanford Nursery input:</u></p> <p>The school state that it is deeply committed to promoting the Welsh language and culture across all aspects of school life:</p>			
Information about after-school activities which provide additional opportunities to use the Welsh language at school e.g Urdd clubs	The school building currently accommodates an after school provision Clwb Caleb-run as a separate business through a lettings agreement between 3pm-5pm Monday to Friday.	Positive	Ysgol Gymraeg Rhydaman and Ysgol Bro Banw deliver a variety of after-school activities and additional opportunities to use the Welsh language at school e.g. via Urdd and Menter Iaith.	Positive
Information about whether the school provides facilities for members of the community to learn Welsh, or	N/A	Neutral	Ysgol Gymraeg Rhydaman and Ysgol Bro Banw provide a variety of activities for members of the community e.g. a community kitchen at Ysgol Bro Banw.	Positive

facilities for them to engage in activities through the medium of Welsh				
Possible effects a policy decision may have on opportunities for persons to use the Welsh language, or treating the Welsh language no less favourably than the English language	<p>This proposal does not treat the Welsh language less favourably than the English language.</p> <p>Ysgol Gymraeg Rhydaman and Ysgol Bro Banw provide a plethora of activities and events through the medium of Welsh which will enrich the experiences of children and their families.</p> <p>Carmarthenshire also recognise the importance of the use of Welsh beyond the classroom. We will, through the council's Welsh Language Promotion Strategy and by working with our partners, continue to maximise opportunities for all Carmarthenshire pupils and our communities to use Welsh in all aspects of everyday life.</p> <p>The consultation documentation will be bilingual meaning that the public will have the opportunity to read documentation relating to the proposal in Welsh and English and provide a response in their preferred language medium.</p>	Positive	N/A	N/A

Information on how the proposal aligns with the Authority's Welsh in Education Strategic Plan and any steps that may need to be taken in the future as a result of the change to continue to comply with the plan or achieve the plan's targets.	<p>The vision: The year 2050: <i>The Welsh language is thriving, the number of speakers has reached a million, and it is used in every aspect of life. Among those who do not speak Welsh there is goodwill and a sense of ownership towards the language and a recognition by all of its contribution to the culture, society and economy of Wales. Our vision is to secure favourable circumstances throughout the country that support language acquisition and use of Welsh language skills. We want to see an increase in language transmission in the family, early introduction of Welsh to every child and an education system that provides Welsh language skills for all.</i></p> <p>Welsh Government has approved Carmarthenshire County Council's Welsh in Education Strategic Plan (WESP) 2022-2032. It sets out the authority's vision, aim and objectives for developing Welsh-medium education over a ten-year period. The proposal is fully aligned with the authority's Welsh in Education Strategic Plan.</p> <p>Carmarthenshire's Welsh in Education Strategic Plan aims to facilitate an</p>	Positive	N/A	N/A

	<p>increase in the number of people of all ages able to use the Welsh language with their families, in their communities and in the workplace.</p> <p>This proposal would ensure that nursery/three year olds will be able to receive their education through the medium of Welsh at both Ysgol Gymraeg Rhydaman and Ysgol Bro Banw.</p>			
--	--	--	--	--

Conclusion and Summary

Carmarthenshire County Council foresee a positive impact on the Welsh language as a result of this proposal which will offer alternative provision for 3 year olds at Ysgol Bro Banw and Ysgol Gymraeg Rhydaman from September, 2026.

Appendix C - Welsh Language Impact Assessment – Ysgol Bro Banw

Proposal & Background

Carmarthenshire County Council is proposing to change the age range of Ysgol Bro Banw from 4-11 to 3-11 from September, 2026 and this Welsh Language Impact Assessment underpins the Council's proposal.

The [Well-being of Future Generations \(Wales\) Act 2015](#) requires public bodies across Wales named in the act to work towards seven well-being goals, including 'A Wales of Vibrant Culture and Thriving Welsh Language'.

Cymraeg 2050 is the Welsh Government's strategy for the promotion and facilitation of the use of the Welsh language and its vision is that the Welsh language belongs to everyone in Wales. The Welsh Government's ambition for increasing the use of Welsh and the number of people who speak the language is also noted, as is the commitment to work towards securing a million Welsh speakers by 2050 and to continue to encourage more people to use and speak Welsh in their everyday lives.

Cymraeg 2050 is the main policy driving the changes to the statutory process around planning Welsh-medium education. The Cymraeg 2050 strategy notes that Welsh-medium immersion education is the principal method for ensuring that children can develop their Welsh language skills, and for creating new speakers. It also highlights the importance of the early years sector as a point of early entry to immersion education, and as a way to increase demand for Welsh-medium education.

Welsh in Education Strategic Plan (2022-2032) & Welsh Language Promotion Strategy (2023-28)

Carmarthenshire County Council's [Welsh in Education Strategic Plan \(WESP\) 2022 - 2032](#) (WESP), and [Welsh Language Promotion Strategy](#) directly support the Welsh Government's vision and are the cornerstones of the Council's contribution towards meeting the target outlined in the Welsh Government's strategy. This proposal will ensure that Carmarthenshire County Council can carry out its statutory duties in relation to Welsh-medium education through its Welsh in Education Strategic Plan (WESP) and to facilitate an increase in the number of people of all ages able to use the Welsh language with their families, in their communities and in the workplace.

Carmarthenshire County Council's Welsh in Education Strategic Plan 2022-32 is clear in its aim and principle of developing our pupils' ability to use both Welsh and English fluently and confidently in a variety of situations. This will enable them to become full

members of the bilingual society of which they are a part, fostering pride in the languages, heritage and culture of Carmarthenshire and Wales.

This proposal will contribute to realising the strategic objectives in the Carmarthenshire [Welsh Language Promotion Strategy \(2023-28\)](#) which aims ‘*To make Welsh the main language of the County and to restore Welsh to a language spoken and used by the majority of inhabitants consistently, and in all aspects of life*’.

The Future Direction of Education Services in Carmarthenshire 2022-2032

[Education Sir Gâr – The Future Direction of Education Service in Carmarthenshire 2022-2032](#) has clear priorities focussed around four key themes, tied into Our National Mission, the four purposes of Curriculum for Wales. Purpose 8 states that Carmarthenshire County Council “*will champion the Welsh Language and pride in Carmarthenshire’s unique heritage and culture*”.

Curriculum for Wales

The Welsh language is an integral part of [Curriculum for Wales](#) with the aim of ensuring an increase in the number of confident Welsh speakers within the statutory education system, and to ensure that in future, all learners can use Welsh after they have left school. It emphasises the fact that Welsh will remain compulsory up until the age of 16.

Who will this proposal effect directly?

The proposal will have an impact on pupils aged 3 and their families in the Ammanford area.

This proposal will have a positive impact on children and young people by offering additional choice in terms of Welsh-medium early years education from 3 years old at Ysgol Bro Banw. This in turn, from an early age, will offer children and young people Welsh language skills that they can use in all walks of life and in particular when they leave school and start work.

This proposal will allow Carmarthenshire County Council to increase the provision offered at Ysgol Bro Banw, which will have a positive impact on children and young people in the Ammanford area, regardless of their background, or language of their family, ensuring that more and more children and young people develop Welsh language skills that can be used in everyday life.

We expect any impact to be positive, due to the following:

- Children and young people can take advantage of Welsh-medium education from 3 years of age
- The aims of this proposal will help Carmarthenshire County Council fulfil its commitments to the Welsh language, Welsh speakers and Welsh speaking communities.

Impact Criteria	Description	Status of the impact	Have any measures been identified to mitigate any negative impact or to create more positive opportunities?	Final impact (following mitigation methods)
The school's Language Category (formal)	<p>The school's language is defined as Category 3.1 3= Welsh medium (3 classes) 1=English Medium (14 classes)</p> <p>Category 3 – Welsh Medium. This category is described as - <i>Welsh is the school's main language of internal communication. Communication with parents and carers is in either English, Welsh or bilingually as needed. This is a school with a strong Welsh language ethos at its core, supporting and enabling learners' Welsh language use in all social context in and outside of school. In a Welsh immersion setting all learners are taught fully in Welsh, with English being used on occasion to ensure understanding during early immersion. From aged 7 onwards at least 80% of learner's school activities (both curricular and extra-curricular) will be in Welsh.</i></p>	Neutral	N/A	N/A

	<p>Category 1 – English Medium. This category is described as - <i>English is the school's main language of internal communication as well as with parents and carers. There is recognition that creating a Welsh language ethos within the school will support and encourage positive attitudes towards Welsh language use. A learner in a school of this category will be able to read, write, speak and listen in English according to age and ability, and will have some understanding of Welsh. Welsh will be taught and assessed as part of the Area of Learning and Experience (AoLE) for languages, literacy and communication. At least 15% of the learners' school activities (both curricular and extra-curricular) will be in Welsh.</i></p> <p>This proposal would not affect the language of the pupils' education at the school.</p>			
The school's Language Category (informal)	<p>This proposal could strengthen the opportunities for pupils to use the Welsh language stream formally and informally with their peers from a younger age.</p> <p>With the change to 3-11 provision, we aim to work with all our partners to promote the benefits of bilingualism to ensure that all</p>	Positive	N/A	N/A

	parents/carers and families can make an informed decision at the earliest possible time in their child's life.			
Information about Welsh language standards at the school	<p><u>Local Authority Input:</u></p> <p>Ysgol Bro Banw provide strong support for pupils who attend the Welsh-medium, English-medium and the specialist teaching provision classes. The innovative and exciting inquiry-based curriculum stimulates pupils' interests and enthusiasm for learning. Although many pupils start school with relatively weak skills, most make strong progress in their learning over time.</p> <p>Although most pupils attending the Welsh-medium classes do not speak the language at home, they make strong progress in their Welsh language skills during their time at the school.</p> <p>Following an Estyn inspection in January 2024, it was noted 'Most younger pupils in the English-medium classes make appropriate progress in using incidental Welsh, particularly during morning welcome sessions. They respond suitably to familiar prompts and questions and join in enthusiastically with songs and rhymes.</p>	Positive	N/A	N/A

	<p>As pupils move through the school, a majority use a limited range of vocabulary and understand basic words and phrases in class and during Welsh lessons'. Since the inspection, the school has strengthened its commitment to promoting the Welsh language. Developing pupils' Welsh language skills in the English medium classes is a key priority for the school and they are proactively working along side the Tîm Gwella'r Gymraeg to develop and improve pupils' Welsh skills.</p> <p>The school's curriculum places a strong and effective emphasis on developing pupils' understanding of their 'cynefin' - their local area - and the history and heritage of Wales. Pupils have positive attitudes towards learning about Wales and the Welsh language. For example, Nursery pupils use maps confidently to visit Ammanford to recognise its distinctive natural and human features. Year 5 pupils apply their digital skills effectively to create interesting animations about the story of Taliesin and Year 4 pupils, along with their peers in the Welsh medium class, develop their writing skills successfully to create detailed online travel reviews following a trip on the Brecon Mountain Railway.</p>		
--	--	--	--

	<p>Impact of Proposed Change</p> <p>Extending the age range to admit 3-year-olds would have a positive impact on the Welsh language. Early immersion at nursery age is a well-established approach to strengthening bilingual development. Learners would benefit from a longer period of exposure to the language, supporting greater fluency and confidence. This change would provide a strong linguistic foundation that will enable pupils to develop into ambitious, capable, and bilingual learners within the same establishment from nursery through to the end of the primary phase.</p>			
Information about after-school activities which provide additional opportunities to use the Welsh language at school e.g Urdd clubs	<p>The school takes part in Urdd activities, such as Sports festivals, residentials etc. There has been an Urdd after school club with children preparing for Eisteddfod competitions. On a rotation basis there is also a Welsh after school club for Key Stage 2 children. The school engage regularly in Menter Iaith activities - Dawnsio, Cwis Clem and Cwis Llyfrau.</p>	Positive		N/A

Information about whether the school provides facilities for members of the community to learn Welsh, or facilities for them to engage in activities through the medium of Welsh	The school use the community kitchen to deliver parent nutritional and cooking workshops. These are delivered by our Family Project Officer who is fluent in Welsh and they are delivered bilingually.	Positive		
Possible effects a policy decision may have on opportunities for persons to use the Welsh language, or treating the Welsh language no less favourably than the English language	<p>This proposal would introduce Welsh-medium early years provision at the school and therefore increase the opportunities to use the Welsh language.</p> <p>This proposal does not treat the Welsh language less favourably than the English language.</p> <p>Carmarthenshire also recognise the importance of the use of Welsh beyond the classroom. We will, through the council's Welsh Language Promotion Strategy and by working with our partners, continue to maximise opportunities for all Carmarthenshire pupils and our communities to use Welsh in all aspects of everyday life.</p>	Positive	N/A	N/A

	The consultation documentation will be bilingual meaning that the public will have the opportunity to read documentation relating to the proposal in Welsh and English and provide a response in their preferred language medium.			
Information on how the proposal aligns with the Authority's Welsh in Education Strategic Plan and any steps that may need to be taken in the future as a result of the change to continue to comply with the plan or achieve the plan's targets.	<p>The vision: The year 2050: <i>The Welsh language is thriving, the number of speakers has reached a million, and it is used in every aspect of life. Among those who do not speak Welsh there is goodwill and a sense of ownership towards the language and a recognition by all of its contribution to the culture, society and economy of Wales. Our vision is to secure favourable circumstances throughout the country that support language acquisition and use of Welsh language skills. We want to see an increase in language transmission in the family, early introduction of Welsh to every child and an education system that provides Welsh language skills for all.</i></p> <p>Welsh Government has approved Carmarthenshire County Council's Welsh in Education Strategic Plan (WESP) 2022-2032. It sets out the authority's vision, aim and objectives for developing Welsh-medium education over a ten-year period. The proposal is fully aligned with the</p>	Positive	N/A	N/A

	<p>authority's Welsh in Education Strategic Plan.</p> <p>Carmarthenshire's Welsh in Education Strategic Plan aims to facilitate an increase in the number of people of all ages able to use the Welsh language with their families, in their communities and in the workplace.</p>			
--	--	--	--	--

Conclusion and Summary

Carmarthenshire County Council foresee a positive impact on the Welsh language as a result of this proposal to change the age range of Ysgol Bro Banw from 4-11 to 3-11 from September, 2026.

Appendix D - Welsh Language Impact Assessment Ysgol Gymraeg Rhydaman

Proposal & Background

Carmarthenshire County Council is proposing to change the age range of Ysgol Gymraeg Rhydaman from 4-11 to 3-11 from September, 2026 and this Welsh Language Impact Assessment underpins the Council's proposal.

The [Well-being of Future Generations \(Wales\) Act 2015](#) requires public bodies across Wales named in the act to work towards seven well-being goals, including 'A Wales of Vibrant Culture and Thriving Welsh Language'.

Cymraeg 2050 is the Welsh Government's strategy for the promotion and facilitation of the use of the Welsh language and its vision is that the Welsh language belongs to everyone in Wales. The Welsh Government's ambition for increasing the use of Welsh and the number of people who speak the language is also noted, as is the commitment to work towards securing a million Welsh speakers by 2050 and to continue to encourage more people to use and speak Welsh in their everyday lives.

Cymraeg 2050 is the main policy driving the changes to the statutory process around planning Welsh-medium education. The Cymraeg 2050 strategy notes that Welsh-medium immersion education is the principal method for ensuring that children can develop their Welsh language skills, and for creating new speakers. It also highlights the importance of the early years sector as a point of early entry to immersion education, and as a way to increase demand for Welsh-medium education.

Welsh in Education Strategic Plan (2022-2032) & Welsh Language Promotion Strategy (2023-28)

Carmarthenshire County Council's [Welsh in Education Strategic Plan \(WESP\) 2022 - 2032](#) (WESP), and [Welsh Language Promotion Strategy](#) directly support the Welsh Government's vision and are the cornerstones of the Council's contribution towards meeting the target outlined in the Welsh Government's strategy. This proposal will ensure that Carmarthenshire County Council can carry out its statutory duties in relation to Welsh-medium education through its Welsh in Education Strategic Plan (WESP) and to facilitate an increase in the number of people of all ages able to use the Welsh language with their families, in their communities and in the workplace.

Carmarthenshire County Council's Welsh in Education Strategic Plan 2022-32 is clear in its aim and principle of developing our pupils' ability to use both Welsh and English fluently and confidently in a variety of situations. This will enable them to become full

members of the bilingual society of which they are a part, fostering pride in the languages, heritage and culture of Carmarthenshire and Wales.

This proposal will contribute to realising the strategic objectives in the Carmarthenshire [Welsh Language Promotion Strategy \(2023-28\)](#) which aims ‘*To make Welsh the main language of the County and to restore Welsh to a language spoken and used by the majority of inhabitants consistently, and in all aspects of life*’.

The Future Direction of Education Services in Carmarthenshire 2022-2032

[Education Sir Gâr – The Future Direction of Education Service in Carmarthenshire 2022-2032](#) has clear priorities focussed around four key themes, tied into Our National Mission, the four purposes of Curriculum for Wales. Purpose 8 states that Carmarthenshire County Council “*will champion the Welsh Language and pride in Carmarthenshire’s unique heritage and culture*”.

Curriculum for Wales

The Welsh language is an integral part of [Curriculum for Wales](#) with the aim of ensuring an increase in the number of confident Welsh speakers within the statutory education system, and to ensure that in future, all learners can use Welsh after they have left school. It emphasises the fact that Welsh will remain compulsory up until the age of 16.

Who will this proposal effect directly?

The proposal will have an impact on pupils aged 3 and their families in the Ammanford area.

This proposal will have a positive impact on children and young people by offering additional choice in terms of Welsh-medium early years education from 3 years old at Ysgol Gymraeg Rhydaman. This in turn, from an early age, will offer children and young people Welsh language skills that they can use in all walks of life and in particular when they leave school and start work.

This proposal will allow Carmarthenshire County Council to increase the provision offered at Ysgol Gymraeg Rhydaman, which will have a positive impact on children and young people in the Ammanford area, regardless of their background, or language of their family, ensuring that more and more children and young people develop Welsh language skills that can be used in everyday life.

We expect any impact to be positive, due to the following:

- Children and young people can take advantage of Welsh-medium education from 3 years of age
- The aims of this proposal will help Carmarthenshire County Council fulfil its commitments to the Welsh language, Welsh speakers and Welsh speaking communities.

Impact Criteria	Description	Status of the impact	Have any measures been identified to mitigate any negative impact or to create more positive opportunities?	Final impact (following mitigation methods)
The school's Language Category (formal)	<p>The school's language is defined as Category 3 – Welsh Medium. This category is described as - <i>Welsh is the school's main language of internal communication. Communication with parents and carers is in either English, Welsh or bilingually as needed. This is a school with a strong Welsh language ethos at its core, supporting and enabling learners' Welsh language use in all social context in and outside of school. In a Welsh immersion setting all learners are taught fully in Welsh, with English being used on occasion to ensure understanding during early immersion. From aged 7 onwards at least 80% of learner's school activities (both curricular and extra-curricular) will be in Welsh.</i></p> <p>This proposal would not affect the language of the pupils' education at the school.</p>	Neutral	N/A	N/A

The school's Language Category (informal)	This proposal will strengthen the opportunities for pupils to use the Welsh language their peers from a younger age.	Positive	N/A	N/A
Information about Welsh language standards at the school	<p><u>Local Authority Input:</u></p> <p>The Welsh language and celebrating pupils' Welshness are at the heart of Ysgol Gynradd Gymraeg Rhydaman's life and work. The headteacher models and embraces the values of Welshness, happiness, respect and friendship which form the basis of her vision. This vision is clearly and successfully communicated with the wider school community.</p> <p>Teachers collaborate effectively to provide a broad and balanced curriculum that is rooted in the local area. Through the planning of a range of stimulating and engaging activities, they provide valuable opportunities for pupils to learn about the culture, history and heritage of the local area and Wales. For example, staff provide regular opportunities for pupils to learn about local historical places, encouraging pupils to make comparisons between the lives of residents from different periods and their lives today. Staff work closely with members of the</p>	Positive	N/A	N/A

	<p>community, which is fundamental in deepening pupils' awareness and appreciation of their 'cynefin' or local area.</p> <p>One of the school's notable strengths is the collective commitment of staff to developing pupils' Welsh oracy skills. Adults model high-quality Welsh and actively encourage its use across the school, fostering pride in the language and a deep respect for the heritage and culture of both the local area and Wales as a whole. As a result, nearly all pupils use Welsh enthusiastically and demonstrate a genuine pride in their cultural identity. Teachers collaborate effectively to deliver a broad and balanced curriculum that is firmly rooted in the local context and the wider Welsh landscape.</p> <p>The Welsh speaking and communication skills of nearly all of the youngest pupils develop well. As pupils progress through the school, the literacy skills of nearly all pupils develop effectively in both languages. By the time they reach the top of the school, they communicate confidently and naturally in Welsh.</p> <p>The reading skills of nearly all pupils develop soundly in line with their progression step. They use these skills</p>		
--	--	--	--

	<p>increasingly effectively in Welsh and English and explain the content in detail. They vary their tone of voice where necessary and use clear expression when reading aloud. Most of the school's youngest pupils develop early writing skills soundly by making marks skilfully in a range of forms and on a range of materials such as paper, sand and card. At the top of the school, pupils build securely on their writing skills in both languages. They write in a range of genres and adapt the style and structure to different texts confidently and effectively.</p> <p>Impact of Proposed Change</p> <p>Extending the age range to admit 3-year-olds would have a positive impact on the Welsh language. Early immersion at nursery age is a well-established approach to strengthening bilingual development. Learners would benefit from a longer period of exposure to the language, supporting greater fluency and confidence. This change would provide a strong linguistic foundation that will enable pupils to develop into ambitious, capable, and bilingual learners.</p> <p><u>Ysgol Gymraeg Rhydaman input:</u> Welsh is the language of all school life</p>		
--	--	--	--

	<p>and work, during and beyond school hours. Fostering pride in our country, language and culture is one of our values as a school, and all our activity revolves around this. As stated by Estyn in their report of our recent inspection <i>"The Welsh language and the celebration of the pupils' Welshness are at the heart of the life and work of the school. As a result, almost all pupils are keen to communicate in Welsh and show pride in the culture and heritage of their community and Wales at large."</i> (October 2024)</p> <p>Changing the age-range from 4-11 to 3-11 would provide opportunities for earlier Welsh language immersion from the age of 3. This could strengthen the language skills of pupils as they progress through the school.</p>			
Information about after-school activities which provide additional opportunities to use the Welsh language at school e.g Urdd clubs	<p>The school run after-school clubs over periods throughout the year, including sports, gardening, digital, arts and crafts, and triathlon clubs. These clubs vary from year to year and from season to season. We also have an after-school care club provided by Menter Dinefwr, which is held at the school every night from 3.30-5.30pm. These are all carried out through the medium of Welsh, as this is the</p>			

	language of the school, and is an additional opportunity for our pupils to socialise through the medium of Welsh.	Positive		N/A
Information about whether the school provides facilities for members of the community to learn Welsh, or facilities for them to engage in activities through the medium of Welsh	The school provide information to parents by email about opportunities to learn and develop their Welsh and their confidence to use it e.g. Clwb Cwtsh. We also accept students on the Sabbatical Course with the University of Wales Trinity Saint David to school during the year, so that they have the opportunity to practise their Welsh and gain confidence to use it. We hold Welsh language concerts and shows every Autumn and Christmas, we hold Fairs every Christmas and Summer, our Parents and Teachers Association meets several times a term to organise activities, and we offer opportunities for our parents to come to Maths and Language sessions at school to understand how to support their children at home - these are all opportunities for our parents to undertake an activity through the medium of Welsh. Everything we do in the school is through the medium of Welsh, and we present and welcome bilingually at the beginning and end of every concert and show. We use translation tools at meetings where necessary e.g. Governors meeting and parents meeting with Estyn.	Positive		

Possible effects a policy decision may have on opportunities for persons to use the Welsh language, or treating the Welsh language no less favourably than the English language	<p>This proposal would increase the Welsh-medium early years provision and therefore increase the opportunities to use the Welsh language.</p> <p>This proposal does not treat the Welsh language less favourably than the English language.</p> <p>Carmarthenshire also recognise the importance of the use of Welsh beyond the classroom. We will, through the council's Welsh Language Promotion Strategy and by working with our partners, continue to maximise opportunities for all Carmarthenshire pupils and our communities to use Welsh in all aspects of everyday life.</p> <p>The consultation documentation will be bilingual meaning that the public will have the opportunity to read documentation relating to the proposal in Welsh and English and provide a response in their preferred language medium.</p>	Positive	N/A	N/A
Information on how the proposal aligns with the Authority's Welsh in	The vision: The year 2050: <i>The Welsh language is thriving, the number of speakers has reached a million, and it is used in every aspect of life. Among those who do not speak Welsh there is goodwill and a sense of ownership towards the</i>	Positive	N/A	N/A

<p>Education Strategic Plan and any steps that may need to be taken in the future as a result of the change to continue to comply with the plan or achieve the plan's targets.</p>	<p><i>language and a recognition by all of its contribution to the culture, society and economy of Wales. Our vision is to secure favourable circumstances throughout the country that support language acquisition and use of Welsh language skills. We want to see an increase in language transmission in the family, early introduction of Welsh to every child and an education system that provides Welsh language skills for all.</i></p> <p>Welsh Government has approved Carmarthenshire County Council's Welsh in Education Strategic Plan (WESP) 2022-2032. It sets out the authority's vision, aim and objectives for developing Welsh-medium education over a ten-year period. The proposal is fully aligned with the authority's Welsh in Education Strategic Plan.</p> <p>Carmarthenshire's Welsh in Education Strategic Plan aims to facilitate an increase in the number of people of all ages able to use the Welsh language with their families, in their communities and in the workplace.</p> <p>This proposal supports Outcome 1 'More nursery age / three-year olds receive their education through the medium of Welsh'.</p>			
--	--	--	--	--

	<p>Changing the age-range of Ysgol Gymraeg Rhydaman from 4-11 to 3-11 would provide Welsh-medium part-time 3-year-old education provision at Ysgol Gymraeg Rhydaman, strengthening the transition between Welsh medium nursery provision and primary education.</p> <p>This proposal would provide earlier opportunities for Welsh language immersion from the age of 3, thus developing foundational language skills during pupils' formative years and ensuring that they are supported to do so throughout their educational journey.</p>			
--	--	--	--	--

Conclusion and Summary

Carmarthenshire County Council foresee a positive impact on the Welsh language as a result of this proposal to change the age range of Ysgol Gymraeg Rhydaman from 4-11 to 3-11 from September, 2026.