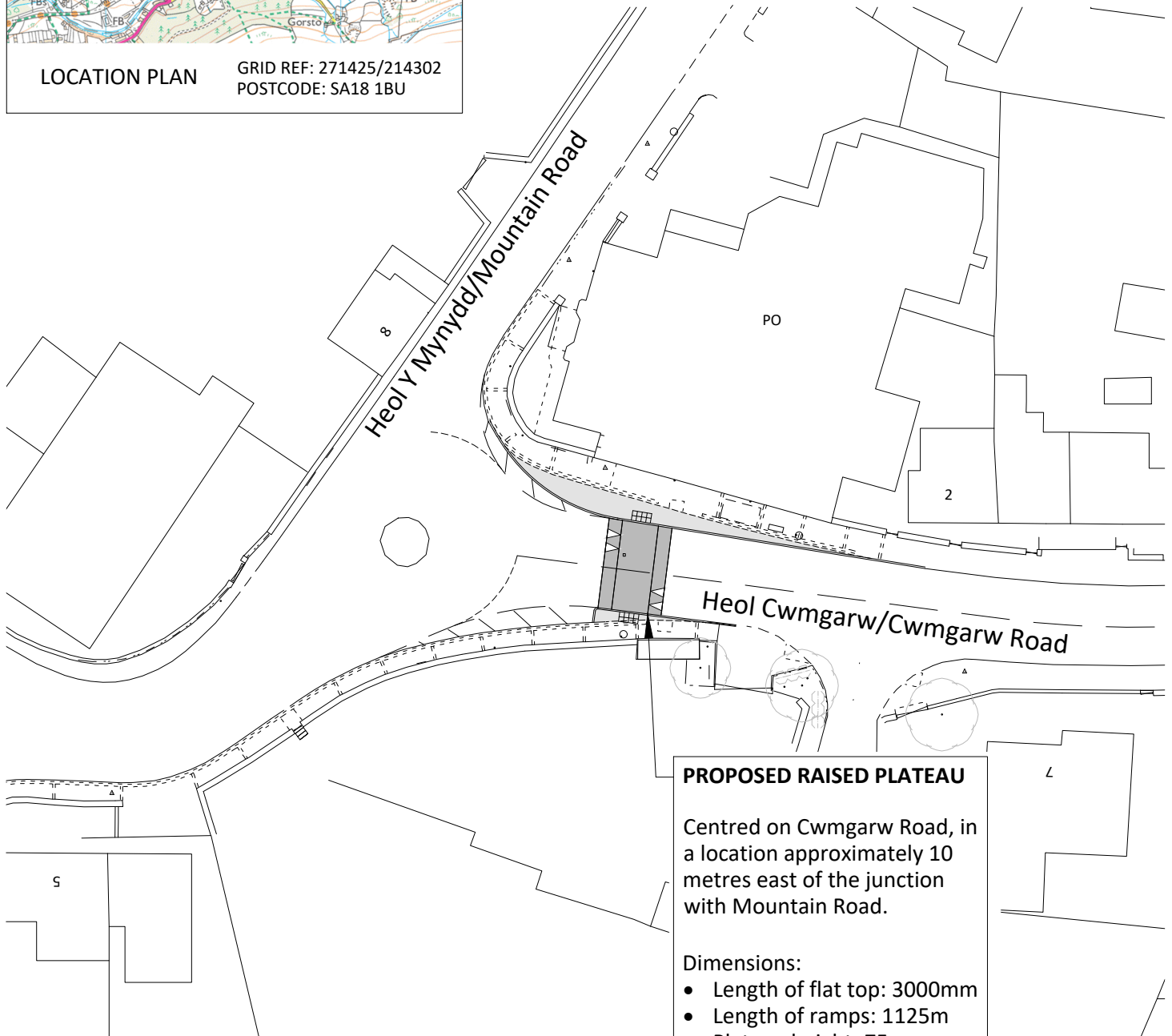

LOCATION PLAN

GRID REF: 271425/214302
POSTCODE: SA18 1BU

**PROPOSED RAISED PLATEAU**

Centred on Cwmgarw Road, in a location approximately 10 metres east of the junction with Mountain Road.

Dimensions:

- Length of flat top: 3000mm
- Length of ramps: 1125m
- Plateau height: 75mm

© Crown copyright and database rights 2025
Ordnance Survey AC0000810849

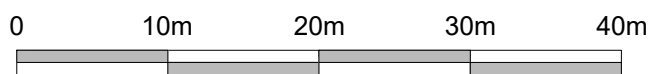

SCALE 1:500

Gwasanaethau Dylunio Peirianegol



Engineering Design Services

Adrian Harries B.Eng (Hons). C.Eng, M.I.C.E
Rheolwr Gwasanaethau Dylunio Proffesiynol
Professional Design Services Manager,

Project

PROPOSED VERTICAL MEASURE

Title

BRYNAMMAN CROSSING POINT

REV	DATE	REVISION DESCRIPTION	REV BY	CHECKED	DATE CHD
Status CONSULTATION					
Made By	Date	Checked	Date	Authorised	Date
ME	17/12/25	SNG	19/12/25	VP	19/12/25
Scale			Project no.		
1:500			80/0041/361		
			Drawing no.	Revision	
			41361/E01	-	