

Proposal to change the age range from 4-11 to 3-11 at Laugharne VCP School

Consultation Document



sirgar.llyw.cymru
carmarthenshire.gov.wales

Cyngor Sir Gâr
Carmarthenshire
County Council



Contents

Introduction	3
School Subject to Proposal	3
Background	5
The Proposal – Laugharne VCP School.....	6
Specific factors where proposals concern adding nursery classes	9
School(s) likely to be affected by the proposal	13
Quality and Standards in Education	15
Need for places and the impact on accessibility of schools.....	18
Resourcing of education and other financial implications.....	18
Other general factors.....	20
Admissions.....	21
The Consultation Process	22
Integrated Impact Assessment.....	26
Appendix A - Response Form	27
Appendix B - Welsh Language Impact Assessment.....	31

Introduction

This consultation document outlines the joint proposal between the Governing Body of Laugharne VCP School and Carmarthenshire County Council to change the age range of Laugharne VCP School from 4-11 to 3-11 from September 2026.

The document offers an opportunity for parents, carers, school staff and anyone else who has an interest to put forward any comments, observations or alternative options they wish to be considered. Following consultation on the proposed change, the Council will consider whether these proposals should be implemented.

The Consultation Period for the proposal will take place from 4/9/2025 to 16/10/2025. Any responses received after the closing date will be unable to be considered.

The consultation process will follow the guidelines established by the Welsh Government (WG) as stated in the [School Organisation Code \(2018\)](#).

School Subject to Proposal

		Laugharne VCP School
School Location		Orchard Park Laugharne Carmarthenshire SA33 4TE
Age Range		4-11
School Category (Community [C], Voluntary Aided [VA], Voluntary Controlled [VC])		Voluntary Controlled
Language Category		1 (English Medium)
Number of registered Pupils (PLASC 2025)	Nursery Age	3
	Reception – Y.6	50
	Total	53
Number of pupils previously on the register (PLASC)	January 2024	68
	January 2023	71
	February 2022	80
	April 2021	85
Pupil Projections	January 2026	44
	January 2027	45
	January 2028	43
	January 2029	40
	January 2030	42
Nursery Capacity 24/25		14
R-Y6 Capacity 24/25		104
Total Capacity 24/25		118
Nursery Capacity 25/26		15
R-Y6 Capacity 25/26		111
Total Capacity 25/26		126

Cost per pupil (2024/25)	£5,048
School Budget (2024/25)	£343,264
Estyn Inspection Result (2022)	Inspection Report Laugharne VCP School 2022 School not in a follow-up category. www.estyn.gov.wales/reports
Building Condition Category (2024)	B

(PLASC) - Pupil Level Annual School Census

Building Condition Category Grades	
Grade A	As new condition
Grade B	Sound, operationally safe, and exhibiting only minor deterioration
Grade C	Operational but major repair or replacement needed in short to medium-term
Grade D	Inoperable or serious risk of major failure or breakdown

Background

The proposal to change the age range of Laugharne VCP School from 4-11 to 3-11 has been prepared in response to the County Council's Cabinet decision to remove Carmarthenshire's Rising 4s Policy, whereby children were historically eligible to enter full-time primary education at the start of the school term in which they turned four years of age.

Following a period of public consultation held between 19 January 2024 and 1 March 2024, the County Council's Cabinet resolved on 25 March 2024 to remove the Rising 4s Policy, which means that, as of 1 September 2025, children will be eligible for full-time school at the start of the term **following their fourth birthday**. From this date, there will be no children in full-time provision who are three years of age.

Children who have turned three are eligible for a minimum of 10 hours per week of non-statutory, approved education provision delivered on a part-time sessional basis, either in one of the county's 42 primary schools which are designated as age 3-11 schools and where this provision is maintained by the Local Authority, or a minimum of 10 hours education in approved non-maintained settings such as day nurseries or Cylchoedd Meithrin. Working parents of eligible 3- to 4-year-olds are able to access up to 30 hours funded combined childcare and education via the Welsh Government's Childcare Offer.

One impact of the removal of the Rising 4s Policy is that children will remain in nursery provision and childcare settings for a term longer than previously. In the short term, this might create an additional demand for provision of non-statutory education for a greater number of three-year-old children, and possibly an increased demand for wrap-around care. Ideally, this demand will be met by the non-maintained sector where providers will be able to expand provision to cater for additional numbers of children for either or both of the minimum 10 hours education and for wrap around care.

In communities where this does not happen and where gaps in provision of the education element exist, the Council proposes changes to some of its 4-11 schools to 3-11 schools. This would enable these schools to deliver the minimum 10 hours non-statutory education element, and provide greater equity of provision across Carmarthenshire. A 3-11 school receives delegated funding for the provision of 3-year-old education on a part-time basis by the Local Authority.

As such, this proposal aims to address the gap in provision of the minimum of 10 hours non-statutory 3-year-old education in the Laugharne area by proposing to change the age range of Laugharne VCP School from 4-11 to 3-11.

The Proposal – Laugharne VCP School

The proposal is to change the age range of Laugharne VCP School from a 4-11 school to a 3-11 school from September, 2026.

Current Arrangements – Status Quo

Laugharne VCP School is a 4-11 English-medium primary school located in the township of Laugharne. The school currently has 53 pupils on roll (PLASC 2025). The school's capacity for the academic year 2025-26 is 118.

At present, Laugharne VCP School is a 4-11 school and therefore is not able to offer part-time non-statutory 3-year-old Early Years education provision. This leads to a gap in the provision of education within the school and its community between the age of 3 and 4.

Early Years education is a non-statutory provision available to 3-year-olds. All 3-year-olds are entitled to 10 hours per week funded placement at a registered setting, through the Early Entitlement Group from the term following their third birthday.

There are various types of Early Years provision available across Carmarthenshire:

- 1 Nursery school
- Nursery/Early Years Classes in 3-11 primary schools
- Provision by the non-maintained sector who are partners in the Early Entitlement Group, such as Early Years Wales, Mudiad Meithrin (MM) and other private providers.

Early years provision for children who live in the Laugharne VCP School catchment area is currently provided at nearby Carmarthenshire maintained primary schools, namely at Llanmiloe CP School, which provides only wrap-around care, with no education element, via a non-maintained provider and Ysgol Griffith Jones, St. Clears which is a 3-11 school providing education. Llanmiloe CP School is located 3 miles and Ysgol Griffith Jones 5 miles from Laugharne VCP School.

In addition, Tavernspite CP School is a 3-11 school providing education for 3-year-olds, located 9.7 miles from Laugharne VCP School and is maintained by Pembrokeshire County Council.

Strengths of the Status Quo

- No change for staff, pupils and the wider community
- No impact on existing non-maintained providers in the community and neighbouring schools.

Weaknesses of the Status Quo

- The school does not offer nursery provision on site and children must travel to access nursery provision in neighbouring schools or in another county.

- The current arrangements do not provide Laugharne VCP School with equitable early years education provision to its neighbouring Carmarthenshire maintained primary schools or neighbouring Local Authority maintained primary school. This negatively impacts the school's ability to retain catchment area pupils and thus, compromises its future sustainability, particularly given that pupil numbers have fallen in recent years and are projected to fall further in the immediate future. Offering nursery provision would encourage children who access it to remain in the school once they are able to progress to full-time reception classes.
- Children within the catchment of the school miss out on education opportunities where parents do not opt for alternative schools. This can disproportionately affect children from economically disadvantaged backgrounds.
- The school has a dedicated, purpose-built, self-contained early years space that includes a cloakroom, kitchen area, quiet room, art and craft area, toilets, and a well-equipped outdoor play area. This part of the school is currently under-utilised.

Benefits and Disadvantages of the proposal:

Benefits	Disadvantages
Addresses the gap in 3-year-old early Years education in the Laugharne area. Provide equity of access to early years education.	Potential reduction in the demand for places at neighbouring 3-11 schools providing education already and any privately-run nurseries and childminders who currently provide all day provision.
Nursery provision available on the school site.	Potential financial risk to the school if demand for nursery places fluctuates. This will always be dependent on parental choice of which school to enrol their children.
Gradual and supported transition for 3-year-olds entering school, starting with half days and progressing to full school days.	Increased workload for staff in providing early years education in existing N2 and reception class.
May attract more pupils to attend the school. This will increase future sustainability and viability of the school.	
Potential for safeguarding of existing posts and possible further employment at Laugharne VCP School if nursery provision is successful and expands.	
Removal of surplus places at the school. This is currently 55% of capacity.	

Early identification of, and support for children with additional learning needs (ALN). Potential for early social and communication interventions, enhancing overall readiness for school life.	
Early support for, and development of children's Welsh language skills through bilingual provision.	

Benefits to accessing Early Years education on a school site

- Early development of foundational skills
- Early identification of learning needs
- Early parental engagement
- Aids transition to primary and lifelong learning
- Support for Welsh language development at an early age

Risk Management:

Risk		Risk Management
1.	Failure to obtain statutory approval to implement the proposal.	Follow guidelines set out in the School Organisation Code 2018.
2.	Effect on local economy through loss of numbers at private nursery providers.	Consult with private providers openly regarding the proposal to understand potential impact.
3.	The nursery class at the school does not receive sufficient applications.	Number of applications cannot be predicted. This will be monitored by the admissions team.

Alternative Options considered:

Alternative Option	Description	Reason for discounting
Option 1	Status Quo - no change to Laugharne VCP School.	Does not address the gap in non-statutory 3-year-old early years education provision in the Laugharne catchment area and would do nothing to address the issue of falling pupil numbers in the school.
Option 2	Provide Early Years Provision at Neighbouring Schools	Pupils must travel out of catchment to access non-statutory 3-year-old early years education provision at other schools. Pupils may not be admitted if there are capacity pressures at the other schools. Additionally, as children below the age of compulsory schooling are not eligible for free transport, it

		could place children and families at a disadvantage, particularly those on lower incomes.
--	--	---

Specific factors where proposals concern adding nursery classes

- ***The standard of nursery education and the sufficiency of accommodation and facilities offered, both in the classroom and outdoors, and the viability of any school that wishes to add nursery places.***

Should the proposal proceed and be implemented as proposed in September 2026, the school's capacity for the 2026/27 academic year is 12 for Nursery Age and 111 for Reception and above giving a total capacity of 123. With currently only 53 on roll, there are sufficient classroom spaces and adequate staffing capacity to integrate a nursery cohort seamlessly within the existing Nursery 2 and Reception cohorts.

However, should the proposal to change the age range of Laugharne VC Primary School from 4-11 to 3-11 proceed, this would result in a school capacity of 105, nursery capacity of 20, total capacity of 125 and admission number of 15. The school is projected to have 48 pupils on roll (including Nursery) at January 2027, demonstrating that there will be sufficient accommodation and facilities to add nursery places from September 2026.

Laugharne School has a dedicated, purpose-built, self-contained early years space that includes a cloakroom, kitchen area, quiet room, art and craft area, toilets, and a well-equipped outdoor play area. There is plenty of outdoor space to facilitate safe outdoor learning.

Given that the school is currently in a soft federation arrangement and sharing a head teacher with Llanmiloe CP School and although the school is currently significantly under capacity, the Council considers the school to have a viable future and should the proposal ultimately proceed, it is anticipated that the addition of the nursery class would be expected to have a positive impact on future pupil numbers and on the school's viability.

Laugharne VC Primary School has sufficient classroom space to accommodate Nursery provision in the school. The Foundation Phase Classroom 01/0/043 on the Floor Plan below can accommodate the Nursery pupils. The classroom has space for 20 Nursery Pupils. The school also has sufficient outdoor space to specifically provide for nursery pupils in addition to those of compulsory school age.

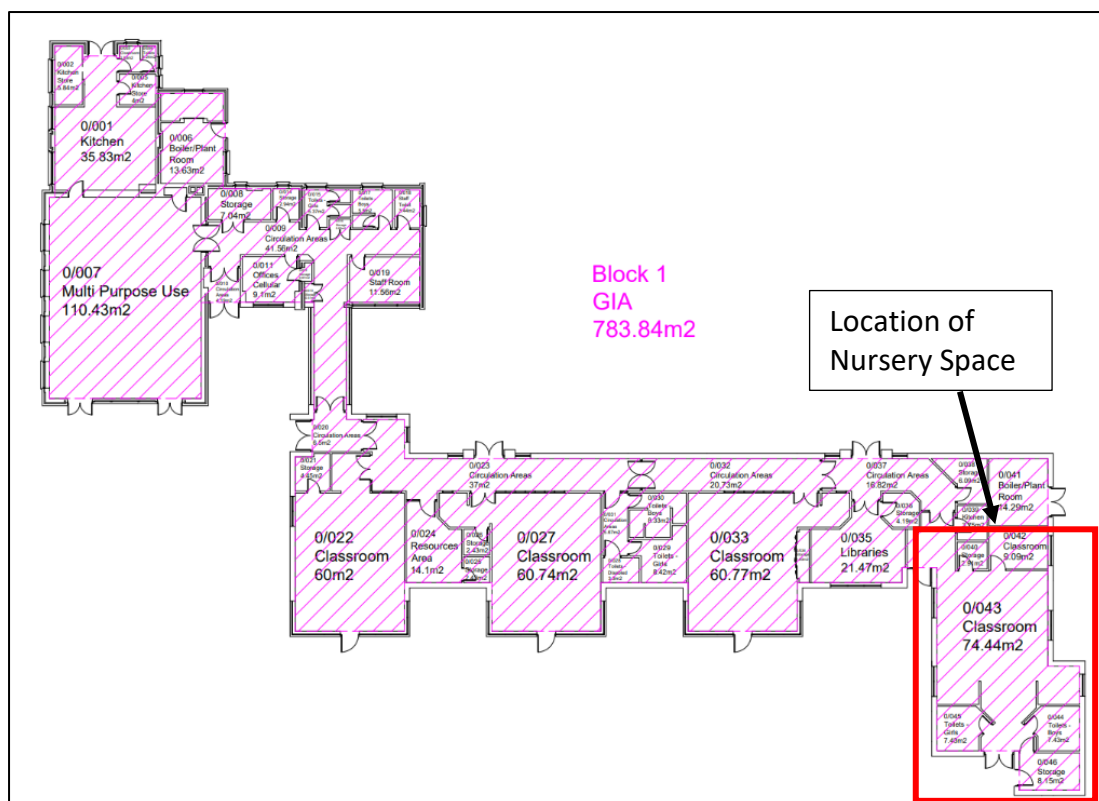

- ***Whether there is a need for additional nursery places in the area.***

There is no private pre-school provision within the township of Laugharne, resulting in a clear gap in early years provision. The school's Governors had already begun exploring options for providing a pre-school setting and has agreed to commence Play and Stay sessions in collaboration with a voluntary mother and toddler group in Laugharne. Establishing formal nursery provision within the school would build upon these efforts and enhance community cohesion by providing a familiar and accessible setting for families from an earlier age.

The school has identified that it consistently loses a number of prospective pupils from within its own catchment to other settings such as Ysgol Griffith Jones in St Clears and Tavernspite School in Pembrokeshire, both of which offer nursery provision for children from the age of three. This puts Laugharne School at a disadvantage, particularly as local families are opting for alternative provisions due to earlier availability. Should this proposal proceed, it is anticipated that it would assist in addressing this inequality of access, which can disproportionately impact on lower income families.

- ***The levels of demand for certain types of nursery education e.g. Welsh medium or provision with a religious character:***

Laugharne VCP School is under the voluntary control of the Church in Wales. Children are taught in accordance with the Christian values of kindness, perseverance, courtesy, respect and honesty.

As an English-medium school committed to promoting the Welsh language, the school intends to ensure that the nursery setting operates bilingually. This will support pupils and their families in progressing along the language continuum in accordance with the Welsh in Education Strategic Plan (WESP) and the aspiration for the school to transition to T2, a bilingual school (Welsh Government Language Category). This approach aligns with wider strategic aims of promoting bilingualism and supporting the Welsh Government's Cymraeg 2050 vision.

- ***The extent to which proposals will integrate early years education with childcare services or are consistent with an integrated approach.***

Should the proposal to change the age range of Laugharne VCP School from 4-11 to 3-11 proceed, it is the aspiration of the school to develop wraparound care provision alongside early years education provision ensuring an integrated approach to education and care. This is consistent with the Governing Body's aim to commence Play and Stay sessions in collaboration with a voluntary mother and toddler group in Laugharne.

Also, the school is in a soft federation arrangement with neighbouring Llanmiloe CP School which hosts a privately run nursery setting providing wrap around care. There are opportunities for further collaboration between the two schools to contribute to a more integrated approach.

- ***The effect of the proposals on other institutions, including private and third sector providers:***

There is no private or third sector provider of nursery education within the catchment of Laugharne VCP School or in the neighbouring school catchments of Llanmiloe CP School and Ysgol Griffith Jones. Ysgol Griffith Jones, as a 3-11 school provides nursery education around 5 miles from the township of Laugharne but is usually at, or close to its capacity. Tavernspite School is also a 3-11 school but located in Pembrokeshire. Laugharne VCP School would offer nursery education in the first instance to those children residing in the Laugharne catchment area and thus within Carmarthenshire and who might otherwise have had no alternative but to cross the county border.

In line with the School Organisation Code (2018), this Consultation Document will be shared with key stakeholders who may be impacted by the proposal. This includes but is not limited to:

- the maintaining or proposed maintaining authority for any school likely to be affected by the proposals.
- the governing body of other schools which the proposer consider are likely to be affected by the proposals.
- in the case of proposals affecting nursery provision any independent or voluntary providers who may be affected including Mudiad Meithrin.

- in the case of proposals affecting nursery provision, the Children and Young People's Partnership and/or the Early Years Development and Childcare Partnerships where present.

School(s) likely to be affected by the proposal

In line with the requirements of the School Organisation Code (2018), details are provided below of schools that are likely to be affected by the proposal.

School Name		Ysgol Griffith Jones	Llanmiloe CP School	Tavernspite CP School
School Location		Station Road, St. Clears Carmarthenshire, SA33 4BT	Llanmiloe, Pendine, Carmarthenshire SA33 4TU.	Tavernspite Whitland Pembrokeshire SA34 0NL
County/LA		Carmarthenshire	Carmarthenshire	Pembrokeshire
Age Range		3-11	4-11	3-11
School Category (Community [C], Voluntary Aided [VA], Voluntary Controlled [VC])		Community	Community	Community
Language Category		3, 2 (Early Years & KS1 Welsh medium / KS2 Dual Stream)	1 (English medium)	1 (English medium)
Number of registered Pupils (PLASC 2025)	Nursery	40	5	27
	Reception – Y.6	257	54	197
	Total	297	59	224
Number of pupils previously on the register (including Nursery) (PLASC)	January 2024	310	58	222
	January 2023	305	62	229
	February 2022	320	73	223
	April 2021	332	74	234
Pupil Projections (excluding Nursery)(2025)	January 2026	251	47	195
	January 2027	250	43	193
	January 2028	252	35	N/A
	January 2029	248	35	N/A
	January 2030	252	37	N/A
Nursery Capacity 24/25		42	6	29
R-Y6 Capacity 24/25		295	59	203
Total Capacity 24/25		337	65	232
R-Y6 Capacity 25/26		286	69	203

School Name	Ysgol Griffith Jones	Llanmiloe CP School	Tavernspite CP School
Total Capacity 25/26	320	77	232
Cost per pupil (2024/25)	£4941	£4782	£4063
School Budget (2024/25)	£1,474,824	£277,380	£883,712
Estyn Inspection Result	Ysgol Griffith Jones Estyn 2020	Llanmiloe CP School Estyn 2023	Tavernspite CP School Estyn 2025
Building Condition Category (2024)	B	B	B

Quality and Standards in Education

The School Organisation Code (2018) requires an analysis of the likely impact of the proposals on the quality and standards of education in the school, taking into account the relevant Estyn inspection areas, which are outlined in the following section.

The County Council's view is that Ysgol Laugharne would provide education for pupils from 3 – 11 which is of at least equivalent quality to the 4 – 11 provision that is currently provided. Therefore, it is not anticipated that implementation of this proposal, should it proceed, would have a negative impact on standards and progress overall.

Current school priorities / Estyn recommendations:

Laugharne VCP School was last inspected by Estyn in October 2022 and currently is in No Follow Up. This means that the school has met the required standards during the inspection and does not require any additional monitoring or intervention from Estyn.

Estyn Recommendations:

R1 Ensure that pupils make good progress in their Welsh speaking skills.

R2 Embed the recently adapted provision to support pupils with additional learning needs in the school's practice.

R3 Share the effective practice that exists in delivering the Curriculum for Wales across the school.

The likely impact of the proposal to change the age range of Laugharne VCP School from 4-11 to 3-11 on:

Learning - standards and progress overall:

- It is noted in the inspection report that during pupils' time at the school, nearly all make good progress in developing a range of skills year on year. Most pupils with additional learning needs make progress that is at least good in their individual targets.
- The oracy skills of most pupils are developing well. Most respond enthusiastically when asked about their work and are happy to describe what they are doing and what they think about their work.
- Nearly all pupils make good progress in their mathematical development. Nearly all younger pupils count to 20 and have good knowledge of odd and even numbers to 10. They engage in independent activities that support the development of their number skills and have a sound mathematical vocabulary.

- Should the proposal proceed, it is unlikely to have a negative impact as learning and progress within the school is strong.

Wellbeing and attitudes to learning:

- It is noted in the inspection report that a strong feature of the school is the positive, caring working relationship that exists between adults and pupils. Nearly all pupils develop high levels of trust and appreciation for teachers and support staff. Pupils' support for one another is mature and thoughtful.
- Nearly all pupils are happy and feel safe at school. They are exceptionally well-behaved in the classrooms and around the school. They are very polite and welcoming, and treat each other, staff and visitors with respect and courtesy.
- Should the proposal proceed, it is unlikely to have a negative impact as the school has an effective strong inclusive culture, with pupils caring well for their peers.

Teaching and learning experiences:

- Estyn inspectors identified that teachers provide a range of engaging learning experiences that promote pupils' creativity well through drama, art and music. The broad and balanced curriculum enables pupils to acquire the necessary knowledge and skills in literacy, numeracy, and information and communication technology to ensure continuity and progression in their learning.
- The school's provision for personal and social education develops pupils' understanding of their own well-being and that of others effectively. Teachers integrate aspects of diversity skilfully into their planning.
- There is a supportive working relationship between staff and pupils across the school. Staff also work together effectively to meet the needs of all pupils by sharing ideas and assessing their progress. Staff have high expectations of all pupils and use effective and varied questioning skills to ensure that learning usually proceeds at a good pace.
- It is unlikely that the above proposal, should it proceed, will have a negative impact, as there is a broad and balanced curriculum to ensure continuity and progression for all.

Care, support and guidance:

- It is noted in the inspection report that all members of staff work purposefully together to create a caring community and a safe learning environment for pupils and adults. The school ensures that the health and well-being of all pupils is a constant priority.
- All staff support pupils to develop a strong awareness of the school values and, as a result, nearly all pupils have developed respect, understanding and tolerance for others. Adults ensure that pupils consider values such as honesty, sustainability, and respect regularly through a varied curriculum.
- The school has ensured that it has robust procedures to identify pupils' additional learning needs and monitor the impact of regular interventions

thoroughly. There is swift identification and support for pupils with ALN and tailored provision to meet their individual needs in the classroom and in support groups. The school provides a wide range of beneficial support to help pupils emotionally and in their learning.

- It is unlikely that the above proposal, should it proceed, will have a negative impact, as there is a caring community and robust school policies and procedures in place that are effective in supporting the wellbeing of all learners.

Leadership and management:

- It is noted in the inspection report that leaders have a clear vision and appropriate strategic objectives, plans and policies for the school. These ensure that staff provide activities that meet the needs of all pupils, so they achieve at least in line with expectations for their stage of development, whatever their background and ability. There is also a clear focus on supporting pupils with additional learning needs and improving staff and pupil wellbeing.
- The improvement processes, together with the robust tracking procedures, provide leaders with a clear focus on identifying the impact of provision on pupils' learning and well-being, whatever their backgrounds and abilities.
- Leaders address national and local priorities well. These include systems for keeping pupils safe, reducing the impact of poverty on educational attainment, preparing to implement the Curriculum for Wales, and refining provision for pupils with ALN.
- Should it proceed, this proposal will likely lead to an increase in pupil numbers that will have a positive effect on the efficient use of resources to contribute to a sustainable future for the school.

Vulnerable groups including learners with ALN and learners from economically deprived backgrounds:

Providing part-time 3-year-old non-statutory Early Years education provision at Laugharne VCP School will benefit vulnerable groups, including learners with Additional Learning Needs (ALN) and learners from economically deprived backgrounds as it enables the early observation and assessment of learners and supports early identification of needs and timely interventions.

Should it proceed, this proposal is likely to enhance learner outcomes, as learners are integrated into an appropriate learning environment from an earlier age.

The ability of the school to deliver the full curriculum at the foundation phase and each key stage of education

The Local Authority has no concerns regarding the quality of teaching and learning and believes the school has the ability to deliver a purposeful curriculum to meet the needs of all learners, should the proposal proceed.

Need for places and the impact on accessibility of schools

The School Organisation Code (2018) requires the Council to take into account the following points in relation to the need for places and impact on accessibility of schools:

- ***The extent to which the proposal would support the targets in the approved Welsh in Education Strategic Plan (WESP)***

Carmarthenshire's [Welsh in Education Strategic Plan \(WESP\) 2022 - 2032](#) aims to facilitate an increase in the number of people of all ages able to use the Welsh language with their families, in their communities and in the workplace.

Laugharne VCP School is currently classified as a Type 1 (English medium) school. This proposal would provide bilingual early years education and would support the school's aspiration to move along the language continuum in accordance with the WESP and the school's potential transition to Type T2 (Transitional to Dual Language). This approach aligns with wider strategic aims of promoting bilingualism and supporting the Welsh Government's Cymraeg 2050 vision.

- ***How the proposal would expand or reduce Welsh language provision.***

The school has the aspiration of moving along the Welsh language continuum and will ensure that the Nursery setting operates bilingually. The school also recognises that one of its Estyn recommendations is to improve children's Welsh language skills and establishing bilingual provision in the nursery setting will support the development plan to achieving this recommendation. Should it proceed, this proposal will enhance Welsh language provision in a wider community where the Welsh language has traditionally not been strong.

An initial Welsh Language Assessment has been undertaken and is attached to this document at Appendix A. This assessment will be reviewed and updated at key points should the proposal proceed.

- ***Whether the proposal will improve access for disabled pupils in accordance with requirements under the Equality Act 2010***

The school has an Accessibility Plan. However, should a pupil require any adaptations to the school, reasonable adjustments will be made for the pupil in line with established Carmarthenshire County Council School Organisation processes.

Resourcing of education and other financial implications

The School Organisation Code (2018) requires the Council to take into account the following points in relation resourcing of education and other financial implications:

- ***What effect the proposal will have on surplus places in the area***

It is anticipated, if it proceeds, that the proposal to change the age range of Laugharne VCP School from 4-11 to 3-11 would positively impact on the removal of surplus places at the school. This is currently approximately 55% of the total school capacity.

- ***The recurrent cost of the proposal over a period of at least 3 years and whether the necessary recurrent funding is available***

Local Authority maintained 3-11 schools receive delegated formula funding for the provision of 3-year-old education on a part-time basis. This equates to 50% of the per capita funding for primary pupils. In 2025-26 this figure is £2044 per pupil on roll at the time of the Pupil Level Annual School Census (PLASC) which takes place in the January preceding the following financial year. This is additional funding for a school currently designated as 4-11 and which becomes 3-11.

- ***The sources from which capital funding will be provided***

If approved, the proposal is not expected to require any capital funding.

- ***How any capital receipts or recurrent costs savings will be deployed***

There is no transfer or disposal of land or buildings associated with this proposal.

- ***Additional Transport Costs/Learner Travel Arrangements***

As the provision of early years education is for pupils under compulsory school age, free transport would not be available for pupils. However, there may be cost implications for additional transport if these children reach the age of eligibility for transport to be provided and if they reside in the school's catchment and over the two mile limit.

The proposal may have a positive impact on the travel arrangements of those who currently travel outside of their catchment area to access early years education. Providing early years education in the Laugharne VCP School catchment area may encourage pupils to attend their catchment area school.

- ***Staffing***

The school has sufficient staffing available from its existing complement to meet the needs of nursery children. Nursery provision will be integrated with the existing N2 / Reception class. The costs of staffing will be met from the school's delegated revenue budget which will be supplemented by additional pupil number funding as detailed above.

Other general factors

The School Organisation Code (2018) requires relevant bodies to take into account the following points in relation to other general factors:

- ***Impact of the proposal on educational attainment among children from economically deprived backgrounds***

Providing part-time 3-year-old non-statutory early years education provision at Laugharne VCP School will benefit vulnerable groups, including learners with Additional Learning Needs (ALN) and learners from economically deprived backgrounds as it enables the early observation and assessment of learners and supports early identification of needs and timely interventions.

- ***Equality issues, including those identified through equality impact assessments***

No apparent equality issues have been identified through the Integrated Impact Assessment at this stage. It does not highlight any disproportionate impact on any protected characteristics. The assessment will be updated as necessary.

Admissions Arrangements

The County Council is the Admissions Authority for Laugharne VCP School:

The School Admissions Unit,
Carmarthenshire Local Authority,
Department for Education and Children,
Building 3,
Spilman Street,
Carmarthen,
SA31 1LE

Tel No: 01267 246449

E-mail: admissions@carmarthenshire.gov.uk

Admission to Early Years

Early Years education is a non-statutory provision available to 3-year-olds and an application for admission to provision within a school will have to be made to the correct Admissions authority by the published closing date.

All 3-year-olds are entitled to a minimum of 10 hours per week funded placement, at a registered setting, through the Early Entitlement Group from the term following their third birthday.

Children will normally be admitted to Early Years provision in schools where it is available on a part-time basis at the beginning of the term following their third birthday.

Child's 3 rd Birthday	Admission Term
1 September – 31 December	Spring Term
1 January – 31 March	Summer Term
1 April – 31 August	Autumn Term

Parents / guardians do not have a right of appeal if a place is not offered at an Early Years setting of their choice.

There is no automatic right to continue into full time education if you have been offered a part-time education place. A formal application must be made to the correct admissions authority.

Further information on the School Admissions policy and process can be found on the Council website.

Should this proposal proceed, in line with Welsh Government statutory requirements Admissions would undertake a one-off admissions exercise outside of normal arrangements, to ensure parents within the Laugharne community have an opportunity to apply for the nursery age places commencing September 2026.

The Consultation Process

The consultation on this proposal will follow guidelines established by the Welsh Government as stated in the School Organisation Code (2018).

Who will be consulted?

A link to the Consultation Document will be provided to the following stakeholders (as determined by the School Organisation Code (2018)):

- *Parents (and where possible prospective parents) carers and guardians, and staff members of schools affected by the proposals;*
- *in the case of proposals affecting secondary provision, parents of pupils attending primary schools from which pupils normally transfer to that secondary school;*
- *the maintaining or proposed maintaining authority for any school likely to be affected by the proposals;*
- *any other local authority (including those in England, where appropriate) likely to be affected - including in the case of dedicated SEN provision any authority placing or likely to place pupils with SEN in it;*
- *the Church in Wales and Roman Catholic Diocesan Authority for the area in which any school likely to be affected is located;*
- *any other appropriate religious body for any school likely to be affected by the proposals;*
- *the governing body of any school which is the subject of the proposals;*
- *the governing body of other schools which the proposer consider are likely to be affected by the proposals;*
- *the Welsh Ministers;*
- *Constituency and Regional Assembly Members (AMs) and Members of Parliament (MPs) representing the area served by/intended to be served by any school which is the subject of the proposals;*
- *Estyn;*
- *teaching and staff trade unions representing teachers and other staff at any school which is the subject of the proposals;*
- *the relevant Regional Education Consortium;*
- *the Police and Crime Commissioner for the area served by/intended to be served by any school which is the subject of the proposals;*
- *any community or town council for the area served by/ intended to be served by any school which is the subject of the proposals;*
- *in the case of proposals affecting nursery provision any independent or voluntary providers who may be affected including Mudiad Meithrin;*
- *in the case of proposals affecting nursery provision, the Children and Young People's Partnership and/or the Early Years Development and Childcare Partnerships where present;*
- *in the case of proposals affecting SEN provision, any relevant health or third sector bodies with an interest;*
- *in the case of proposals affecting secondary provision, any further education institutions serving the area of the school; and*
- *in the case of proposals affecting Welsh language provision, the Welsh Language Commissioner.*

Consultation with Pupils

Pupils will be provided with a copy of a Children and Young People Consultation Document.

Additionally, there will be an opportunity for the pupils (School Council as a minimum) of the schools subject to the proposals to participate in the consultation process during a session which will be undertaken by an Education Support Advisor.

The information gathered from the consultation with pupils will form part of the Consultation Report which will be submitted to the Cabinet for consideration following the consultation period.

What Happens Next?

Stage 1. Consultation Period

The consultation period for the proposals starts on 4th September 2025 and ends on 16th October 2025.

You can submit your views in favour of or against a proposal. Responses received during the consultation period will not be treated as statutory objections. If you wish to object, you will need to do so in writing during the statutory objection period.

Considering your views

During the consultation period you can ask questions, express your views or provide alternative options for consideration by no later than 16/10/2025 through one of the following methods:

- Completing an online survey using the following link: [SNAP SURVEY](#)
- Sending an email to: MEPConsultations@carmarthenshire.gov.uk
- Writing a letter to the following address: Cllr Jane Tremlett, Chair of Governors, Laugharne VCP School, Orchard Park, Laugharne, SA33 4TE.
- Or completing a paper copy response form (Appendix A) and returning to Cllr Jane Tremlett, Chair of Governors, Laugharne VCP School, Orchard Park, Laugharne, SA33 4TE or by sending a scanned copy via e-mail to: MEPConsultations@carmarthenshire.gov.uk

Please note that you only need to submit your response through one communication method.

Comments submitted during the consultation period will be recorded and summarised in a Consultation Report.

Following the consultation period, a Consultation Report will be published on both of the school's and Carmarthenshire County Council's website at least 2 weeks prior to the publication of a Statutory Notice.

The Governing Body and Cabinet Member for Education and the Welsh Language for Carmarthenshire County Council will consider the Consultation Report and jointly decide whether or not to proceed with the proposal.

Stage 2. Statutory Notice Objection Period

If the Governing Body and Cabinet Member decide to continue with the proposal the Governing Body and Carmarthenshire County Council will publish a document known as a Statutory Notice.

The Statutory Notice will be published on both the school's and Carmarthenshire County Council's website and posted at the gates of the school. Copies of the notice will be made available to pupils, parents, guardians, and staff members of the school (the school may also distribute the notice by email).

The Statutory Notice will set out the details of the proposal and invite anyone who wishes to object or support to do so in writing within a period of 28 days.

If objections are received an Objection Report will be published on the school's and Carmarthenshire County Council's website. Hard copies of the report will also be available on request from the school. The report will summarise the issues or supportive comments raised and provide the Governing Body and Carmarthenshire County Council's response.

If no objections are received, the proposal moves straight to determination.

Stage 3. Determination

The Governing Body and the Cabinet member for Education and the Welsh Language will determine the proposal. This means that it will make a final decision on whether the change proposed goes ahead. The The Governing Body and Cabinet Member may decide to approve, reject or approve the proposal with modifications. In doing so, it will take into account any statutory objections that it received.

Following determination of proposals all interested parties will be informed and advised of the availability of the decision which will be published electronically on the school's and Carmarthenshire County Council's website.

All stakeholders will be notified of the decision and publication of the Objection Report within 7 days of the determination.

Potential Statutory Process Timeline

An indicative statutory process timeline is shown below:

Stage	Description	Duration
1	Consultation Issue of this consultation document to identified and other interested parties.	September 2025 – October 2025 At least 42 days (including at least 20 school days)
2	Consultation Report A Consultation Report will be considered by the Governing Body and Cabinet member for Education and the Welsh Language before a decision on whether or not to proceed to publish a statutory notice. OR alternatively proposal ends.	January 2026 or sooner The Consultation Report will be published on the school's and Carmarthenshire County Council's website at least 2 weeks prior to the publication of a statutory notice
3	Statutory Notice If the decision is made to proceed then a statutory notice will be published. The notice will outline details of the proposal and be published on the school's and Council's web sites and be displayed near the entrance of the school. Copies of the notice will be made available to the school to distribute to parents, guardians and staff members. The statutory notice will give details on how you may record your objections to the proposal.	February – March 2026 or sooner Minimum 28 days (including at least 15 school days and not including the date of publication)
4	Objection Report If objections are received an Objection Report will be published on the school's and Carmarthenshire County Council's websites. Hard copies of the report will also be available on request. The report will summarise the issues or supportive comments raised and provide the	June 2026 or sooner Before the end of 7 days beginning with the date of its determination.

	<p>Governing Body's and Cabinet member's response.</p> <p>If no objections are received, the proposal moves straight to determination.</p>	
5	<p>Determination</p> <p>The Governing Body will determine the proposal. It may decide to approve, reject or approve the proposal with modifications, in doing so the Governing Body and Cabinet Member will take into account any statutory objections received.</p> <p>Following determination of proposals all interested parties will be informed and advised of the availability of the decision which will be published electronically on Carmarthenshire County Council's website.</p>	<p>June 2026 or sooner</p> <p>Decision made within 16 weeks of the end of the objection period</p>

Integrated Impact Assessment

An integrated impact assessment (IIA) has been undertaken to help us to ensure we have considered how different groups and services could be affected by our proposals, enabling us to strengthen positive aspects and mitigate any potentially negative impacts.

The integrated impact assessment incorporates the requirements of the following Acts into one Impact Assessment:

- Well-being of Future Generations (Wales) Act 2015
- Public Sector Equality Duty and the Equality Act 2010
- Socio-Economic Duty 2021
- Welsh Language Measure 2011 and Welsh Language Standards
- United Nations Convention on the Rights of the Child (UNCRC) & Rights of Children and Young Persons (Wales) Measure 2011
- Environment (Wales) Act 2016 – biodiversity and ecosystem resilience
- General Data Protection Regulation

Appendix A - Response Form

The Governing Body of Laugharne VCP School and Carmarthenshire County Council is consulting on the proposal to

- change the age range of Laugharne VCP School from a 4-11 school to a 3-11 school from September 2026.

The following response form allows stakeholders to comment on the proposal, the alternative options and to suggest other alternative options.

Consultees can submit their views in favour of or against a proposal.

Responses received during the consultation period will not be treated as statutory objections. If consultees wish to object, they will need to do so in writing during the statutory objection period.

1. Are you responding as a:

☐ Parent/ carer or guardian

☐ Prospective parent/ carer or guardian

☐ Governor

☐ Staff

☐ Member of the community

☐ Community Council

☐ Other: Please specify

2. Do you support the proposal?

☐ Yes

☐ No

☐ In part

3. Do you have any comments regarding this proposal that you would like us to consider?

4. Are there any other options that you think the Governing Body and County Council should be considering for Laugharne VCP School?

☐ Yes

☐ No

If yes, please outline the alternative option(s):

5. We are required by the Welsh Language Standards to consider the effects of any policy decisions on the Welsh Language.

a. In your opinion, what positive or adverse effects would this proposal have on opportunities for persons to use the Welsh language and to treat the Welsh language no less favourably than the English language?

b. How do you think the proposal could be formulated or revised so that it would have positive or more positive effects on opportunities for persons to use the Welsh language and to treat the Welsh language no less favourably than the English language?

c. How do you think the proposal could be formulated or revised so that it would not have adverse effects or have less adverse effects on opportunities for persons to use the Welsh language and to treat the Welsh language no less favourably than the English language?

6. At the end of the consultation period, a Consultation Report will be published summarising the issues raised by consultees and the Governing Body's response to those issues.

Would you like to be informed of the publication of the Consultation Report:

☐ Yes

☐ No

If yes, please provide an e-mail address or postal address and language preference (English/Welsh):

Thank you for completing the response form.

Completed response forms should be sent to:

Cllr Jane Tremlett, Chair of Governors, Laugharne VCP School, Orchard Park, Laugharne, SA33 4TE.

or by sending a scanned copy via e-mail

MEPConsultations@cararthenshire.gov.uk

Alternatively, you can complete this form online [SNAP SURVEY](#)

Please return your response by 16/10/2025

Appendix B - Welsh Language Impact Assessment

Proposal & Background

The Governing Body of Laugharne VCP School and Carmarthenshire County Council are proposing to change the age range of Laugharne VCP School from 4-11 to 3-11 from September, 2026 and this Welsh Language Impact Assessment underpins the Council's proposal.

The [Well-being of Future Generations \(Wales\) Act 2015](#) requires public bodies across Wales named in the act to work towards seven well-being goals, including 'A Wales of Vibrant Culture and Thriving Welsh Language'.

Cymraeg 2050 is the Welsh Government's strategy for the promotion and facilitation of the use of the Welsh language and its vision is that the Welsh language belongs to everyone in Wales. The Welsh Government's ambition for increasing the use of Welsh and the number of people who speak the language is also noted, as is the commitment to work towards securing a million Welsh speakers by 2050 and to continue to encourage more people to use and speak Welsh in their everyday lives. Cymraeg 2050 is the main policy driving the changes to the statutory process around planning Welsh-medium education. The Cymraeg 2050 strategy notes that Welsh-medium immersion education is the principal method for ensuring that children can develop their Welsh language skills, and for creating new speakers. It also highlights the importance of the early years sector as a point of early entry to immersion education, and as a way to increase demand for Welsh-medium education.

Welsh in Education Strategic Plan (2022-2032) & Welsh Language Promotion Strategy (2023-28)

Carmarthenshire County Council's [Welsh in Education Strategic Plan \(WESP\) 2022 - 2032](#) (WESP), and [Welsh Language Promotion Strategy](#) directly support the Welsh Government's vision and are the cornerstones of the Council's contribution towards meeting the target outlined in the Welsh Government's strategy. This proposal will ensure that Carmarthenshire County Council can carry out its statutory duties in relation to Welsh-medium education through its Welsh in Education Strategic Plan (WESP) and to facilitate an increase in the number of people of all ages able to use the Welsh language with their families, in their communities and in the workplace.

Carmarthenshire County Council's Welsh in Education Strategic Plan 2022-32 is clear in its aim and principle of developing our pupils' ability to use both Welsh and English fluently and confidently in a variety of situations. This will enable them to become full

members of the bilingual society of which they are a part, fostering pride in the languages, heritage and culture of Carmarthenshire and Wales.

This proposal will contribute to realising the strategic objectives in the Carmarthenshire [Welsh Language Promotion Strategy \(2023-28\)](#) which aims *'To make Welsh the main language of the County and to restore Welsh to a language spoken and used by the majority of inhabitants consistently, and in all aspects of life'*.

The Future Direction of Education Services in Carmarthenshire 2022-2032

[Education Sir Gâr – The Future Direction of Education Service in Carmarthenshire 2022-2032](#) has clear priorities focussed around four key themes, tied into Our National Mission, the four purposes of Curriculum for Wales. Purpose 8 states that Carmarthenshire County Council *"will champion the Welsh Language and pride in Carmarthenshire's unique heritage and culture"*.

Curriculum for Wales

The Welsh language is an integral part of [Curriculum for Wales](#) with the aim of ensuring an increase in the number of confident Welsh speakers within the statutory education system, and to ensure that in future, all learners can use Welsh after they have left school. It emphasises the fact that Welsh will remain compulsory up until the age of 16.

Who will this proposal effect directly?

The proposal will have an impact on pupils aged 3 and their families in the Laugharne area.

This proposal will have a positive impact on children and young people by offering early opportunities to develop Welsh language skills through bilingual delivery from 3 years old at Laugharne VCP School. This in turn, from an early age, will offer children and young people Welsh language skills that they can use in all walks of life and when they leave school and start work.

This proposal will allow Carmarthenshire County Council to increase the provision offered at Laugharne VCP School, which will have a positive impact on children and young people in the Laugharne area, regardless of their background, or language of their family, ensuring that more and more children and young people develop Welsh language skills that can be used in everyday life. The

community of Laugharne has traditionally not been a strong Welsh speaking one and the proposal will enable children from the age of 3 the opportunity to develop basic Welsh language skills.

We expect any impact to be positive, due to the following:

- Children and young people can take advantage of bilingual education from 3 years of age
- The aims of this proposal will help Carmarthenshire County Council fulfil its commitments to the Welsh language, Welsh speakers and Welsh speaking communities.

Impact Criteria	Description	Status of the impact	Have any measures been identified to mitigate any negative impact or to create more positive opportunities?	Final impact (following mitigation methods)
The school's Language Category (formal)	The school's language is defined as Category 1 – English Medium. This category is described as - <i>English is the school's main language of internal communication as well as with parents and carers. There is recognition that creating a Welsh language ethos within the school will support and encourage positive attitudes towards Welsh language use. A learner in a school of this category will be able to read, write, speak and listen in English according to age and ability, and will have some understanding of Welsh. Welsh will be taught and assessed as part of the Area of Learning and Experience (AoLE) for languages, literacy and communication.</i>	Positive	This proposal will enhance the ability of children to develop their Welsh language skills from an early age as nursery provision will be bilingual.	N/A

	<i>At least 15% of the learners' school activities (both curricular and extra-curricular) will be in Welsh.</i>			
The school's Language Category (informal)	<p>0% of statutory aged pupils speak Welsh at home at Laugharne VCP School. There is traditionally little Welsh spoken within the community of Laugharne.</p> <p>This proposal could strengthen the opportunities for pupils to use the Welsh language formally and informally with their peers from a younger age.</p> <p>With the change to 3-11 provision, the school aims to work with all our partners to promote the benefits of bilingualism to ensure that all parents/carers and families can make an informed decision at the earliest possible time in their child's life.</p>	Positive	N/A	N/A
Information about Welsh language standards at the school	<p><u>Local Authority Input:</u></p> <p><u>Context</u></p> <p>Laugharne VCP School is an English-medium provider with a strong commitment to promoting the Welsh language. The school's strategic direction supports the aspirations of the Carmarthenshire Welsh in Education Strategic Plan (WESP) and aligns with the</p>	Positive	N/A	N/A

	<p>Welsh Government's Cymraeg 2050 vision.</p> <p>A key part of this vision is the school's planned transition to a Category 2 Transitional (T2) setting. Leaders are taking proactive steps to enhance the school's Welsh language provision, including the intention to establish a bilingual Nursery setting. This would provide pupils and their families with a rich, dual-language foundation from the age of three, helping them to progress confidently along the language continuum from the earliest stage.</p> <p>Currently, two-thirds of the teaching staff at Laugharne VCP School are Welsh speakers, enabling the school to model the language consistently and authentically in both formal and informal contexts.</p> <p>Progress since inspection Since the most recent inspection, the school has taken purposeful steps to strengthen the Welsh ethos and create meaningful opportunities for pupils to engage with the language. Initiatives such as Criw Cymraeg, pupil-led Welsh assemblies, and the celebration of cultural events, including Diwrnod Shwmae and Welsh Music Day, have enriched pupils'</p>		
--	--	--	--

	<p>experiences and promoted positive attitudes towards the Welsh language.</p> <p>Welsh is becoming increasingly embedded in day-to-day school life. Staff regularly incorporate incidental Welsh into classroom routines and play, and curriculum planning includes authentic opportunities for pupils to use and enjoy the language. The commitment of leaders and staff to promoting bilingualism is evident, and the school is building a culture of Welsh identity and pride.</p> <p>Impact of Proposed Change Extending the school's age range from 4–11 to 3–11 would have a positive impact on the Welsh language. Establishing a bilingual Nursery provision would enable earlier immersion in Welsh through high-quality, play-based experiences. This is a well-established approach that supports children's cognitive and language development, while laying firm foundations for bilingual learning.</p> <p>The school's existing staffing profile, with two-thirds of teaching staff being Welsh speakers, further strengthens its capacity to deliver this vision. The change would promote continuity in language</p>		
--	--	--	--

	<p>development across Foundation Learning and beyond.</p> <p><u>Laugharne VCP School input:</u> As an English-medium school committed to promoting the Welsh language, we intend to ensure that the Nursery setting operates bilingually. This will support pupils and their families in progressing along the language continuum in accordance with our Welsh in Education Strategic Plan (WESP) and the school's transition to T2 (Welsh Government Language Category). This approach aligns with wider strategic aims of promoting bilingualism and supporting the Welsh Government's Cymraeg 2050 vision.</p> <p>Changing the age-range from 4-11 to 3-11 would provide opportunities for earlier Welsh language immersion from the age of 3. This could strengthen the language skills of pupils as they progress through the school.</p>			
Information about after-school activities which provide additional	Pupils from Laugharne School are offered the opportunity to join the Urdd, and a number take part in local and regional activities, including Eisteddfod		Support for the use of the Welsh language, both inside and outside the classroom, is a key priority within the curriculum.	N/A

<p>opportunities to use the Welsh language at school e.g Urdd clubs</p>	<p>competitions, art and craft, and sporting events.</p> <p>The school holds a traditional school Eisteddfod each year which is very well supported by families. Pupils enter a range of categories including craft, cooking, dance, music, recitation, and choir across all age groups. Parents are encouraged to take part by submitting entries in the parent art and craft competition, helping to create a shared cultural experience. Members of the Governing Body also support the event by volunteering as judges.</p> <p>Year 5 and 6 pupils attend annual Urdd residential camps at Llangrannog or Cardiff Bay, where they benefit from immersive Welsh language and cultural experiences that strengthen oracy skills and cultural understanding.</p> <p>The school has run after-school Welsh club sessions, supported by staff, and is looking to re-establish a regular Welsh club from Autumn 2025, in collaboration with Menter Iaith or similar partners.</p> <p>Menter Iaith regularly visits the school to support both pupils and staff through the delivery of Gemau Buarth, encouraging</p>	<p>Positive</p>	<p>Further collaboration with partners such as Menter Iaith.</p>	
---	--	-----------------	--	--

	<p>pupils to play and interact in Welsh during break times. This supports informal language use and contributes to embedding Welsh in everyday school life.</p> <p>The school celebrates special Welsh cultural days as part of its annual calendar, including Santes Dwynwen Day, Shwmae Su'mae Day, and Dydd Miwsig Cymru (Welsh Music Day). These events help to raise cultural awareness, encourage language use, and foster a sense of pride in Welsh identity among our pupils.</p> <p>The Criw Cymraeg Pupil Voice Committee plays an active leadership role in promoting the Welsh language across the school. They lead weekly assemblies, sharing the Welsh Phrase of the Week, encouraging its use throughout the school. Pupils who have made the most effective use of the phrase are celebrated with Criw Cymraeg awards, fostering a positive, peer-led approach to language use.</p>			
Information about whether the school provides facilities for members of the	Whilst the school does not currently offer structured Welsh learning for the wider community, it is keen to develop this.		The school hopes to work with Mentrau Iaith to deliver bilingual parent-and-toddler sessions and family Welsh learning activities , particularly	Positive

community to learn Welsh, or facilities for them to engage in activities through the medium of Welsh		Negative	as part of the planned Nursery provision. As a school progressing towards Welsh Language Category T2 , it is committed to increasing the presence and use of Welsh throughout school life and strengthening family and community engagement with the language.	
Possible effects a policy decision may have on opportunities for persons to use the Welsh language, or treating the Welsh language no less favourably than the English language	<p>This proposal would increase the Welsh-medium Early Years provision and therefore increase the opportunities to use the Welsh language.</p> <p>This proposal does not treat the Welsh language less favourably than the English language.</p> <p>Carmarthenshire also recognise the importance of the use of Welsh beyond the classroom. We will, through the council's Welsh Language Promotion Strategy and by working with our partners, continue to maximise opportunities for all Carmarthenshire pupils and our communities to use Welsh in all aspects of everyday life.</p>	Positive	N/A	N/A

	The consultation documentation will be bilingual meaning that the public will have the opportunity to read documentation relating to the proposal in Welsh and English and provide a response in their preferred language medium.			
Information on how the proposal aligns with the Authority's Welsh in Education Strategic Plan and any steps that may need to be taken in the future as a result of the change to continue to comply with the plan or achieve the plan's targets.	<p>The vision: The year 2050: <i>The Welsh language is thriving, the number of speakers has reached a million, and it is used in every aspect of life. Among those who do not speak Welsh there is goodwill and a sense of ownership towards the language and a recognition by all of its contribution to the culture, society and economy of Wales. Our vision is to secure favourable circumstances throughout the country that support language acquisition and use of Welsh language skills. We want to see an increase in language transmission in the family, early introduction of Welsh to every child and an education system that provides Welsh language skills for all.</i></p> <p>Welsh Government has approved Carmarthenshire County Council's Welsh in Education Strategic Plan (WESP) 2022-2032. It sets out the authority's vision, aim and objectives for developing Welsh-medium education over a ten-year period. The proposal is fully aligned with</p>	Positive	N/A	N/A

	<p>the authority's Welsh in Education Strategic Plan.</p> <p>Carmarthenshire's Welsh in Education Strategic Plan aims to facilitate an increase in the number of people of all ages able to use the Welsh language with their families, in their communities and in the workplace.</p> <p>This proposal supports Outcome 1 'More nursery age / three-year olds receive their education through the medium of Welsh'. Changing the age-range of Laugharne VCP School from 4-11 to 3-11 would provide Welsh-medium part-time 3-year-old education provision at Laugharne VCP School, strengthening the transition between Welsh medium nursery provision and primary education.</p> <p>This proposal would provide earlier opportunities for Welsh language immersion from the age of 3, thus developing foundational language skills during pupils' formative years and ensuring that they are supported to do so throughout their educational journey.</p>			
--	--	--	--	--

Conclusion and Summary

Initial assessment indicates that there is likely to be a positive impact on the Welsh language should this proposal to change the age range of Laugharne VCP School from 4-11 to 3-11 from September, 2026 proceed.

This Welsh Language Impact Assessment may be updated as required depending on the outcomes of the consultation process.

